

campbell
smith



6/12 West Savile
Gardens,
Edinburgh,
EH9 3AB



- Modern top/third floor flat in move in condition
- Allocated private parking
- Factored development with communal landscaped gardens
- Views to the Observatory & Blackford Hill, Arthur's Seat & Salisbury Crags
- Entryphone
- Sitting room
- Dining kitchen with integrated appliances
- 2 Double bedroom/master with en suite shower room
- Bathroom
- GCH/DG

Offers Over : £285,000

espc / rightmove  / Zoopla /  //  // 

camsmith.co.uk













West Savile Gardens,
Edinburgh, EH9 3AB



Approx. Gross Internal Area
782 Sq Ft - 72.65 Sq M
For identification only. Not to scale.
© SquareFoot 2024

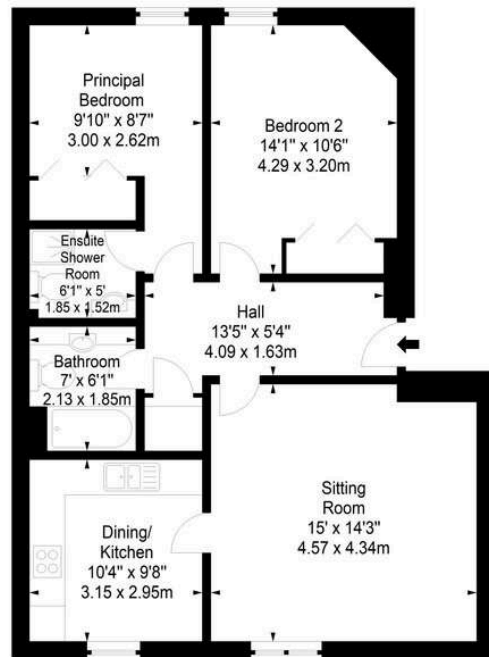
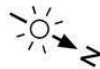

Third Floor

campbell
smith

21 York Place, Edinburgh, EH1 3EN

Tel: 0131 555 2999

Fax: 0131 555 5450

camsmith.co.uk



Extras

The fitted carpets, cooker hood, gas hob, electric oven, washing machine, dishwasher and fridge & freezer are included. The furniture & contents are also available



Buses

West Savile Terrace - 24, Mayfield Road - 12, 24, Blackford Avenue - 9, 24 (ERI/WGH), 38 (ERI/WGH)



Shops

Convenience stores on Mayfield Road & Blackford Avenue, Cameron Toll Shopping Centre



Schools

Sciennes PS, St Peter's RC PS, James Gillespie HS, St Thomas of Aquins RC HS



Parking

Allocated private parking



Council Tax Band - E



EPC - C



Factor

Trinity - details on request



Viewing

Telephone Campbell Smith on
0131 555 2999

DISCLAIMER

While our sales particulars are believed to be accurate and reliable, no guarantee is given as to their correctness or accuracy, if there is any point which is of particular importance to you, please contact the office and we will be pleased to check the information. The mention of any appliances and/or services in these details does not imply that these are in full and efficient working order. All measurements are taken using a sonic measuring tape and are therefore approximate sizes only.