



Gosfield Road, Epsom

Guide Price £645,000



Gosfield Road

Epsom

Charming 3-bed semi-detached house in Epsom Town Centre with vast potential for modernisation. Spacious rooms, conservatory, garage, off-street parking, close to amenities and station. Great opportunity for bespoke living space.

Council Tax band: E

Tenure: Freehold

EPC Energy Efficiency Rating: D

EPC Environmental Impact Rating: G

- Semi-Detached
- Heart of Epsom Town Centre
- Requiring Modernisation
- Through Sitting/Dining Room
- Kitchen
- Conservatory
- Three Bedrooms
- Bathroom & Separate W.C.
- Garage & Off Street Parking
- Minutes Walk To Station

Located in the heart of Epsom Town Centre, this charming 3-bedroom semi-detached house represents a unique opportunity for those seeking a property with vast potential for modernisation and personalisation.

Upon entering the property, one is greeted by a welcoming entrance hall and spacious sitting/dining room that offers a versatile space for entertaining and relaxation. A conservatory overlooking the garden provides an ideal space for enjoying the changing seasons and bringing the outdoors in, whilst the well proportioned kitchen presents a blank canvas for creating a culinary haven tailored to personal taste and style.

Ascending the stairs, three generously sized bedrooms await, each offering ample space and versatility to accommodate various household configurations. A centrally located bathroom and a separate W.C. provide convenience and comfort for residents.

The property includes a garage and off-street parking, ensuring that practical needs for vehicle storage and convenience are met. Furthermore, the proximity to Epsom Town Centre and its array of amenities ensures that residents have easy access to shopping, dining, and leisure facilities.

One of the standout features of this property is its unparalleled location, just minutes away from the station. This offers residents uncomplicated access to public transportation, making commuting and travel a seamless experience.

With its excellent location, generous living spaces, and great potential for improvement, this property in the heart of Epsom Town Centre presents an exciting opportunity for those looking to create a bespoke living space that perfectly suits their needs and lifestyle.

Gosfield Road, KT19

Approximate Area = 1249 sq ft / 116 sq

Garage = 135 sq ft / 12.5 sq m

Total = 1384 sq ft / 128.6 sq m

For identification only - Not to scale

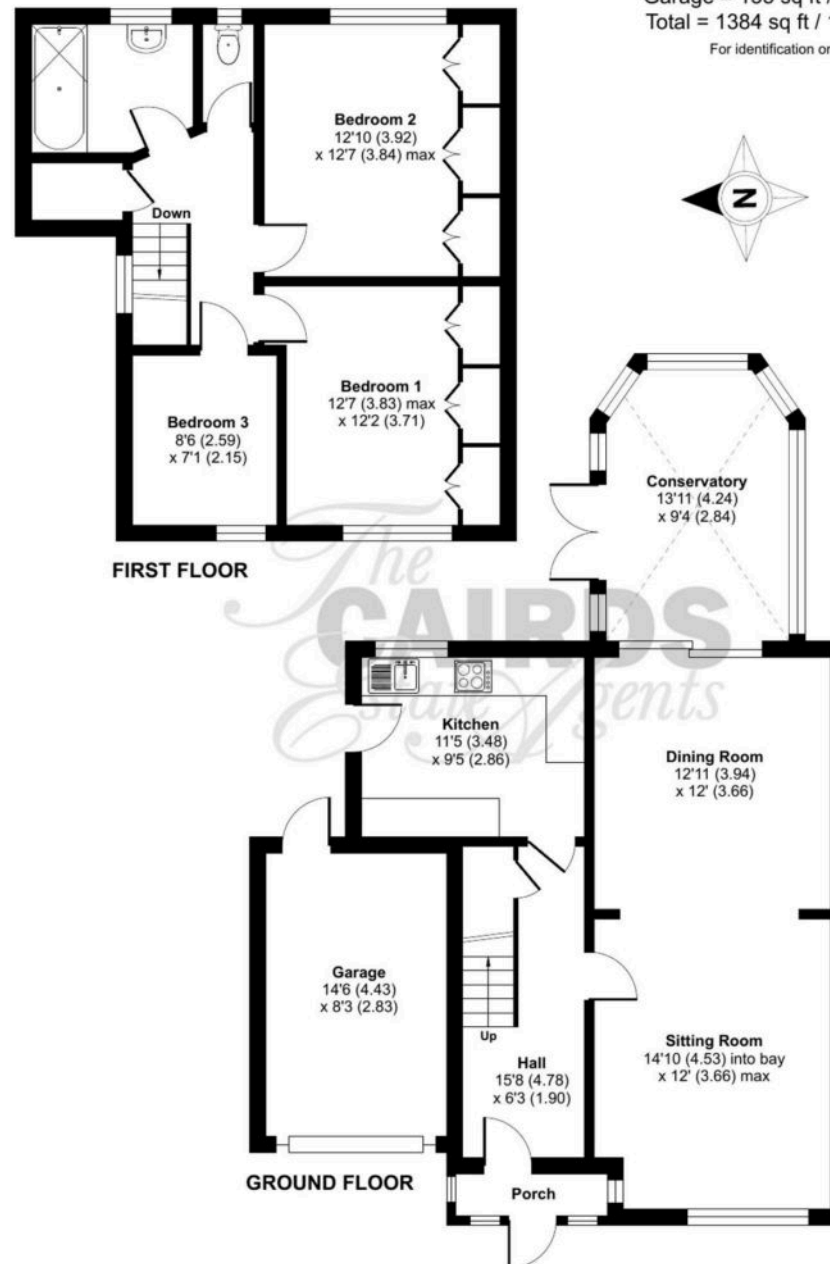





Cairds The Estate Agents

Cairds The Estate Agents, 128-130 High Street - KT19 8BT

01372 743033 • homes@cairds.co.uk • www.cairds.co.uk