



28 Whitegate Way, Tadworth
Tadworth

Guide Price **£525,000**



Whitegate Way

Tadworth

Charming 3-bed semi-detached house with modern interior, spacious living area, kitchen/diner, elegant bathroom, landscaped garden, off-street parking. Ideal location near Tadworth Station, leisure facilities, and Epsom Downs. Perfect for families and professionals seeking suburban living.

Council Tax band: D

Tenure: Freehold

EPC Energy Efficiency Rating: C

EPC Environmental Impact Rating: G

- Cul-De-Sac Location
- Corner Plot
- Living Room
- Modern Kitchen/Diner
- Three Bedrooms
- Well Appointed Bathroom
- Landscaped Rear Garden
- Off Street Parking
- Within A Mile of Tadworth Station
- Easy Reach of Famous Epsom Downs



Nestled in a charming cul-de-sac location, this impressive 3-bedroom semi-detached house is a true gem. Boasting a prime corner plot, this property offers a perfect blend of modern living and tranquil surroundings.

Upon entering, you are greeted by a spacious living room that exudes warmth and comfort, perfect for relaxation or entertaining guests. The modern kitchen/diner is a chef's delight, equipped with a central island, top-of-the-line appliances and ample storage space. The property also features three well-appointed bedrooms, ideal for a growing family or those in need of a home office. The bathroom is elegantly designed, providing a luxurious retreat at the end of a long day.

Stepping outside, you will find a beautifully landscaped garden wrapped around the property, providing a private oasis perfect for al fresco dining or enjoying a morning cup of coffee. The property also benefits from off-street parking, ensuring convenience for residents and guests alike.

Situated within a mile of Tadworth Station and within easy reach of local bus routes, commuting is a breeze, making this property an ideal choice for professionals and families seeking access to London and the local area. Additionally, Tadworth Leisure Centre and the famous Epsom Downs are within a short walk, offering residents a plethora of leisure and outdoor activities and stunning natural beauty.

Don't miss the opportunity to make this delightful property your new home and experience the best of suburban living.

Whitegate Way, Tadworth, KT20

Approximate Area = 850 sq ft / 78.9 sq m

For identification only - Not to scale

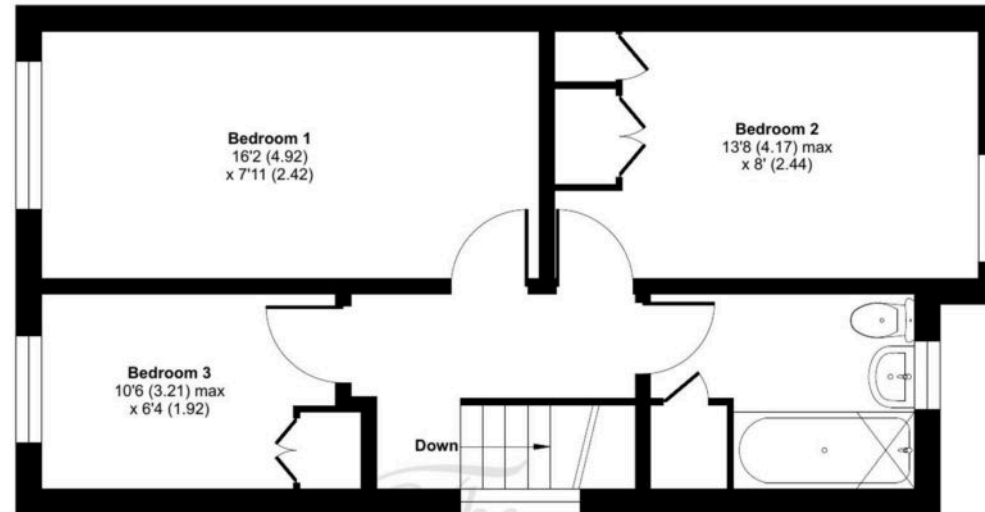

FIRST FLOOR

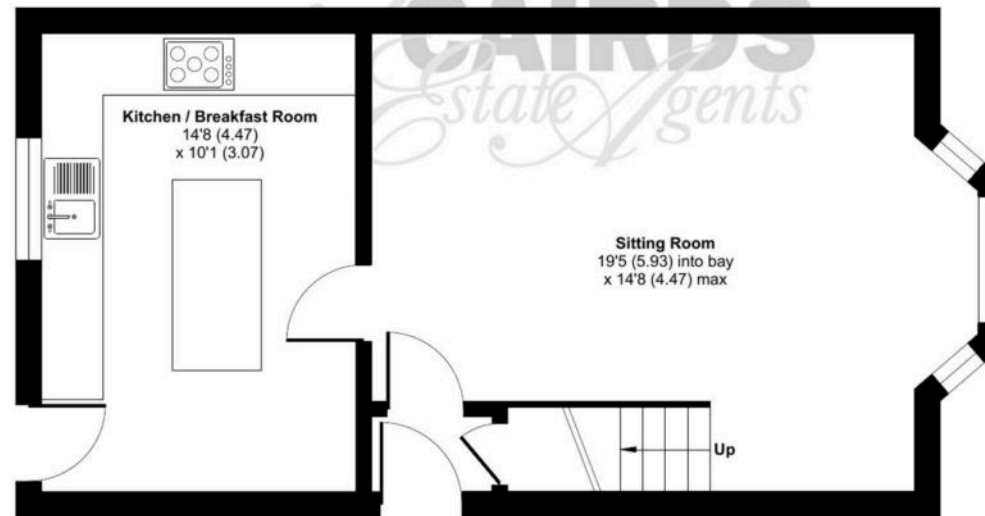

GROUND FLOOR





Cairds The Estate Agents

Cairds The Estate Agents, 128-130 High Street - KT19 8BT

01372 743033 • homes@cairds.co.uk • www.cairds.co.uk