



**10 Winter Close, Epsom**  
Epsom

Guide Price **£625,000**



## 10 Winter Close

Epsom, Epsom

Modern mid-terrace house near town centre & station. Spacious reception/dining room, modern kitchen, cloakroom. 3 bedrooms, 2 baths. Private garden, off-street parking. Close to good schools. Book a viewing today!

Council Tax band: E

Tenure: Freehold

EPC Energy Efficiency Rating: B

EPC Environmental Impact Rating: B

- Modern Well Presented House
- Close to Town Centre & Station
- Large Reception/Dining Room
- Modern Kitchen
- Cloakroom
- Master Bedroom With En-Suite
- Two Further Bedrooms
- Family Bathroom
- Well Maintained Private Rear Garden
- Off Street Parking



# Winter Close, Epsom, KT17

Approximate Area = 1128 sq ft / 104.7 sq m

For identification only - Not to scale

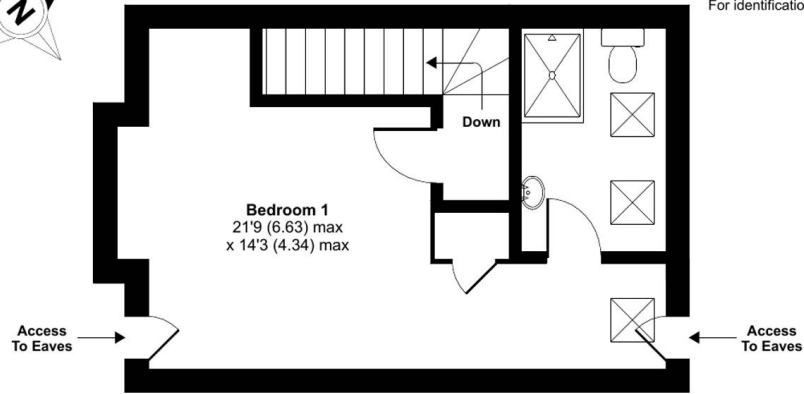

**SECOND FLOOR**

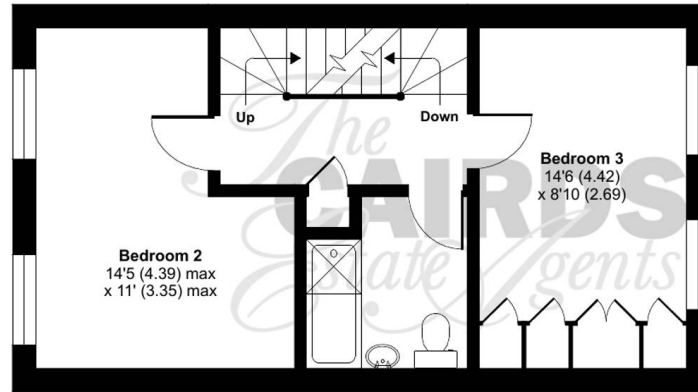

**FIRST FLOOR**

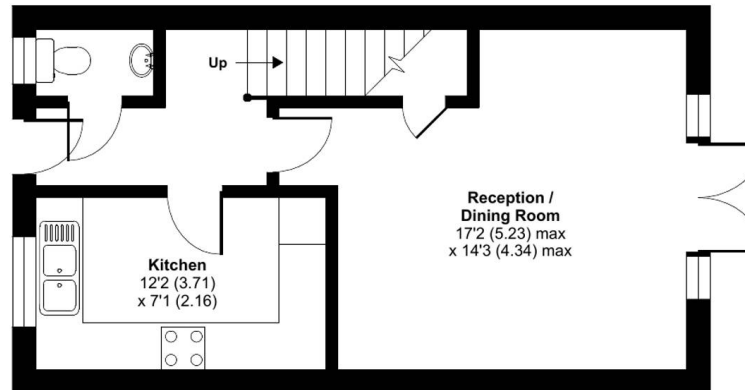

**GROUND FLOOR**



Floor plan produced in accordance with RICS Property Measurement Standards incorporating International Property Measurement Standards (IPMS2 Residential). ©nlchecom 2024. Produced for Cairds. REF: 1182659





## Cairds The Estate Agents

Cairds The Estate Agents, 128-130 High Street - KT19 8BT

01372 743033 • homes@cairds.co.uk • www.cairds.co.uk