



Flat 18, Oaks View Court Lane, Epsom
Epsom

In Excess of **£400,000**



Flat 18

Oaks View Court Lane, Epsom

'Modern 2-bed apartment in a prime location, situated on a park and 8 minute walk to Epsom station. With sleek design, open-plan layout, luxury kitchen, juliet balconies, en-suite, parking, bike storage and communal gardens. Near town centre. Contact for viewing!'

Council Tax band: E

Tenure: Leasehold

EPC Energy Efficiency Rating: B

EPC Environmental Impact Rating: A

- Two Double Bedroom First Floor Apartment
- Modern Throughout with Underfloor Heating
- Open Plan Large Modern Kitchen
- Two Bathrooms with Heated Towel Rails
- Two Juliet Balconies
- Allocated Parking
- Bike Storage
- Views of Court Rec
- Communal Gardens
- Walking Distance to Town Centre and Eight Minute Walk to Train Station



Oaks View, Court Lane, Epsom, KT19

Approximate Area = 798 sq ft / 74.1 sq

For identification only - Not to scale

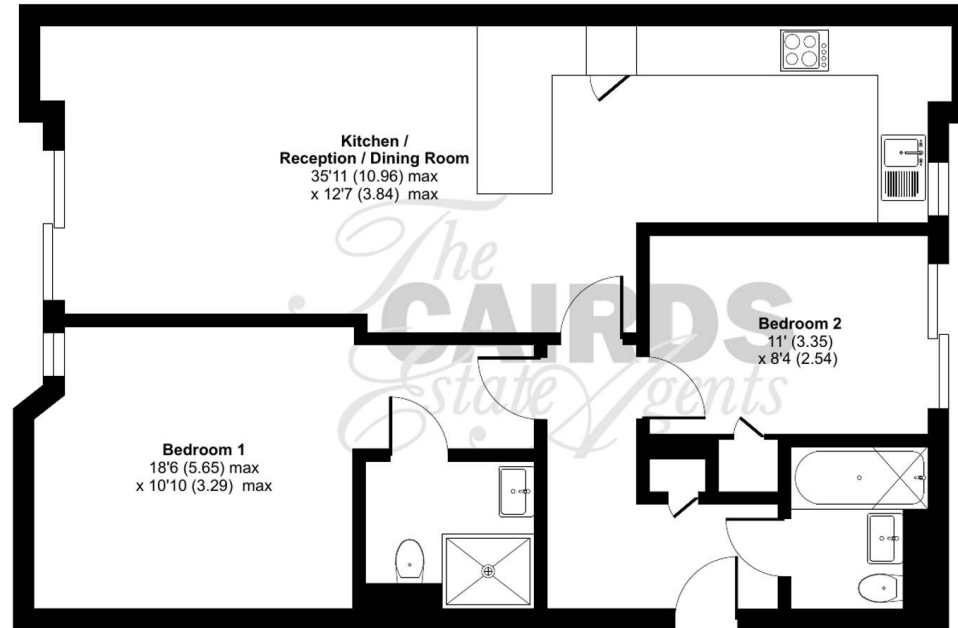

FIRST FLOOR



Floor plan produced in accordance with RICS Property Measurement Standards incorporating International Property Measurement Standards (IPMS2 Residential). ©nlchecom 2024. Produced for Cairds. REF: 1150582





Cairds The Estate Agents

Cairds The Estate Agents, 128-130 High Street - KT19 8BT

01372 743033 • homes@cairds.co.uk • www.cairds.co.uk