



**11 Galen Close, Epsom**  
Epsom

In Excess of **£500,000**



## 11 Galen Close

Epsom, Epsom

Desirable 2-bed terraced house in Manor Park. Renovated living spaces incl. kitchen, living/dining room, ensuite master, south-west garden with decking. 2 parking spaces, playground nearby. Perfect family home! Council Tax band: D

Tenure: Freehold

EPC Energy Efficiency Rating: C

EPC Environmental Impact Rating:

- Renovated Kitchen
- Recent Updates
- Upstairs Bathroom
- Manor Park Development
- Landscaped Garden & Composite Decking
- South West Facing Garden & Shed
- Catchment of Stamford Green Primary
- Family-friendly Location



# Galen Close, Epsom, KT19

Approximate Area = 755 sq ft / 70.1 sq

For identification only - Not to scale

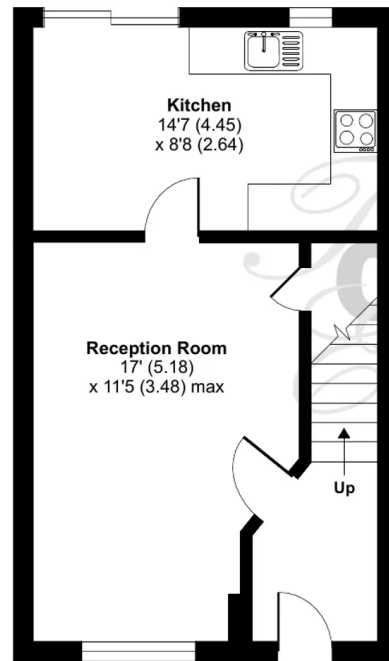

GROUND FLOOR

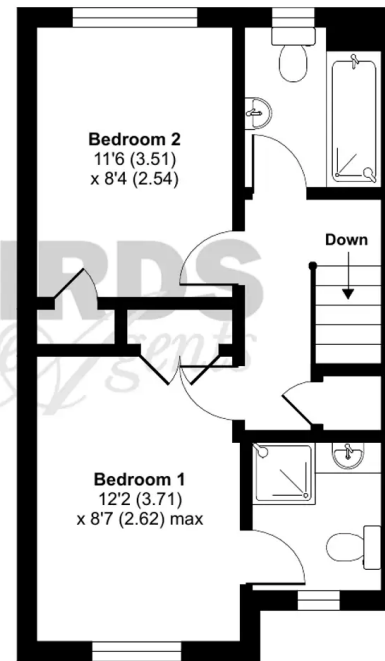

FIRST FLOOR





## Cairds The Estate Agents

Cairds The Estate Agents, 128-130 High Street - KT19 8BT

01372 743033 • homes@cairds.co.uk • www.cairds.co.uk