



5 Downs Lodge Court Church Street, Epsom
Epsom

Guide Price **£375,000**



5 Downs Lodge Court Church Street

Epsom, Epsom

Spacious 2 bed second floor apartment in sought after College area of Epsom. 786 sq ft with light hallway, kitchen, family bathroom, 2 double bedrooms, large living area, parquet flooring. Private garage, parking, share of freehold, communal gardens. Viewings available.

Council Tax band: C

Tenure: Leasehold

EPC Energy Efficiency Rating: C

EPC Environmental Impact Rating:

- Two double Bedrooms
- Top Floor Apartment
- Parquet Flooring
- Single Garage
- Stunning Gardens
- Central Epsom Location
- Share of Freehold



Downs Lodge Court, Church Street, Epsom, KT17

Approximate Area = 786 sq ft / 73 sq m

Garage = 136 sq ft / 12.6 sq m

Total = 922 sq ft / 85.6 sq m

For identification only - Not to scale

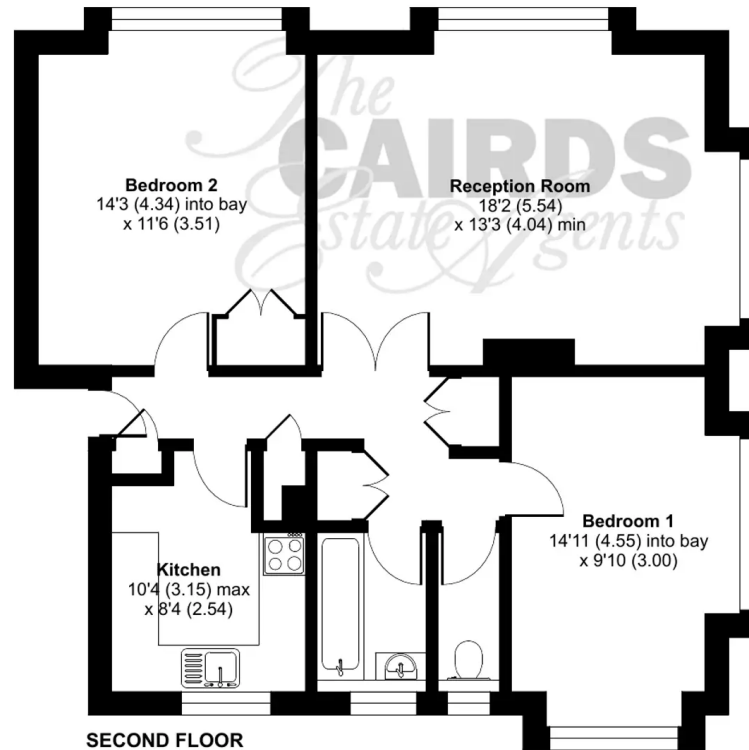
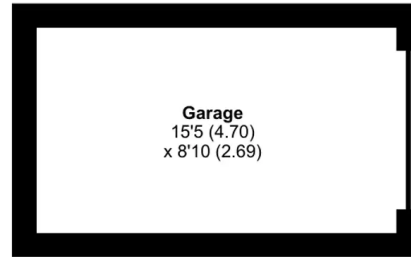

Floor plan produced in accordance with RICS Property Measurement Standards incorporating International Property Measurement Standards (IPMS2 Residential). ©nlcheom 2024. Produced for Cairds - REF: 1082293





Cairds The Estate Agents

Cairds The Estate Agents, 128-130 High Street - KT19 8BT

01372 743033 • homes@cairds.co.uk • www.cairds.co.uk