



Reddinhorn Cottage  
Symonds Yat Rock | Coleford | Gloucestershire | GL16 7NZ



# STEP INSIDE

## Reddinhorn Cottage

Immaculately presented, this charming three-bedroom cottage is ready to move straight into—just unpack and enjoy. With no near neighbours, it features an attractive double-fronted façade and a beautifully finished interior. Set in the sought-after location of Symonds Yat, close to the iconic Symonds Yat Rock, the property offers easy access to the stunning Wye Valley, the wider Forest of Dean, and major road networks for effortless travel.

### Location and situation

The property is situated in a roadside location in the highly sought-after Symonds Yat, nestled in the heart of the Wye Valley within the picturesque Forest of Dean. This stunning destination perfectly combines natural beauty with outdoor adventure and warm, welcoming hospitality. Famous for its dramatic limestone cliffs and breathtaking river views, Symonds Yat is a paradise for walkers, with scenic trails leading to the renowned Symonds Yat Rock, offering panoramic vistas of the valley below. The River Wye provides an abundance of opportunities for kayaking, canoeing, and paddleboarding, as it winds through the picturesque countryside. The area also boasts fantastic mountain biking routes for riders of all abilities, while rock climbers can enjoy the thrill of scaling local crags. Nature enthusiasts may even spot peregrine falcons soaring above. For those seeking relaxation, the charming local pubs such as The Saracen's Head and Ye Old Ferrie Inn serve hearty meals and riverside drinks. Beyond Symonds Yat, the Forest of Dean offers ancient woodlands, scenic trails, and renowned attractions like Puzzlewood and Clearwell Caves, making this an exceptional location for nature lovers, families, and outdoor enthusiasts.

In terms of accessibility, the property is well-connected by road, with good links to nearby towns and cities. The market town of Monmouth is approximately 4 miles away, while the historic town of Ross-on-Wye is around 6 miles. Gloucester and Cheltenham are located approximately 15 to 20 miles away, offering a wide range of amenities, shops, and cultural attractions. For those commuting to larger cities, Bristol is roughly 30 miles away, providing easy access to major transport routes, including the M4 and M5 motorways.

Other Forest of Dean towns are also within easy reach, with Cinderford around 8 miles away, Coleford approximately 9 miles, and Lydney just 10 miles from the property. All three towns offer a variety of local services and amenities, including shops, schools, and leisure facilities. For families, the area is well-served by excellent local schools, including primary and secondary options.

### Step Inside

Wow, wow, wow – this beautifully characterful stone cottage is full of charm!

For day-to-day living, the property is naturally accessed from the parking area via the rear entrance, leading into the utility room, which sits alongside a recently installed cloakroom. The country-style kitchen, also at the rear, features space for a range-style cooker, integrated appliances, and a Belfast sink overlooking the garden.

At the front of the cottage, you'll find a cosy sitting room complete with a fireplace, a bright and airy conservatory/dining room with ample glazing that allows natural light to flood in, and a ground-floor bedroom. If a ground-floor bedroom is not required, this space could serve as a third reception room.

Upstairs, there are two charming double bedrooms brimming with character, along with a stunning family bathroom featuring a separate shower and a beautiful slipper bath.

This delightful home will appeal to buyers seeking a full-time residence, a holiday retreat, or a characterful downsizing opportunity. With its largely standalone position, it also offers a wonderful sense of privacy, free from close neighbours.

### Step Outside

The gardens, approaching a fifth of an acre, have been thoughtfully landscaped to complement the quality of the house. There's a lawn for children to play on, a dedicated area for growing vegetables, and a summerhouse complete with fitted units and a fridge—ideal for keeping drinks cool during the warmer months. The newly installed hot tub (available by separate negotiation) provides the perfect spot to unwind and take in the surroundings. Scenic walks begin right from the doorstep, allowing you to immerse yourself in the stunning local countryside without the need for travel. The rear garden is enclosed, ensuring safety for dogs and children away from the road. Additionally, the property offers several off-road parking spaces close to the cottage.

### Directions

W3W: cigar.than.hardening





















# Reddinhorn Cottage, Symonds Yat Rock, Coleford

Approximate Gross Internal Area

Main House = 843 Sq Ft/78 Sq M

Outbuilding = 228 Sq Ft/21 Sq M

Total = 1071 Sq Ft/99 Sq M

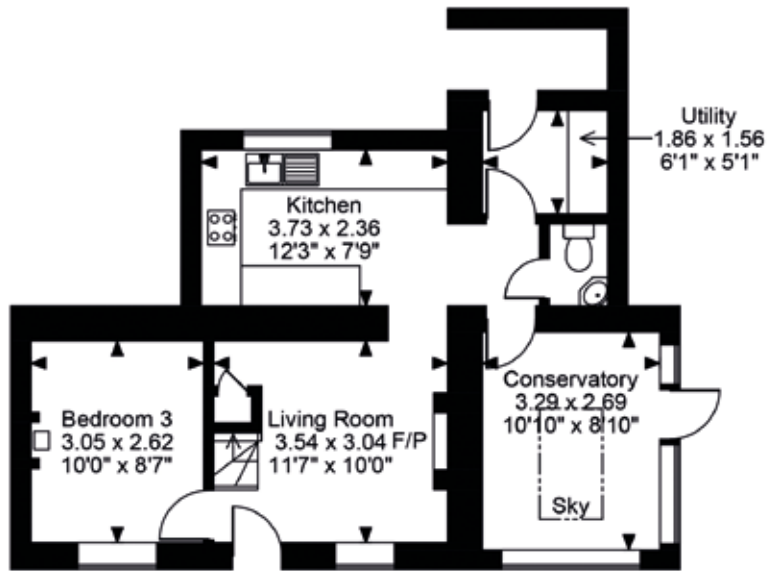
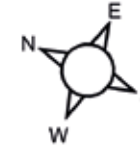

Ground Floor

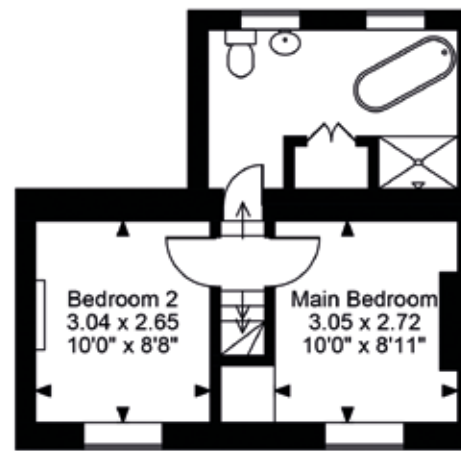

First Floor

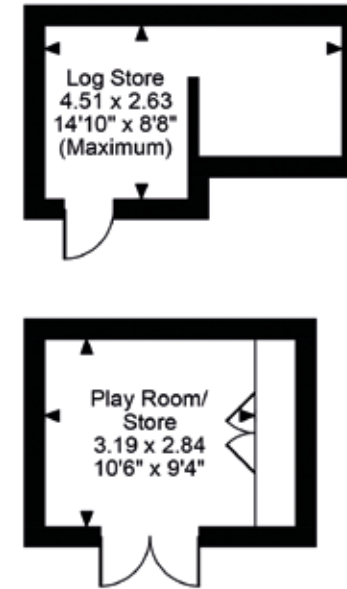

**FOR ILLUSTRATIVE PURPOSES ONLY - NOT TO SCALE**  
 The position & size of doors, windows, appliances and other features are approximate only.  
 © ehouse. Unauthorised reproduction prohibited. Drawing ref. dig/8640769/KRA

Council Tax Band: F  
 Tenure: Freehold

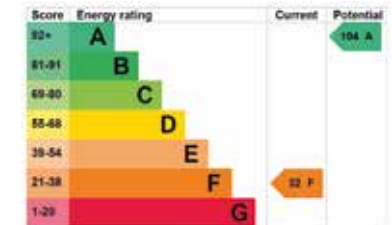

Fine & Country Ross on Wye  
52 Broad Street, Ross-on-Wye, Herefordshire, HR9 7DY  
+441989 764141 | [ross@fineandcountry.com](mailto:ross@fineandcountry.com)

