



Dey  
& King  
& Haria  
estate agents

Gladesmere Court, North Watford

£950 pcm

[www.deykingharia.co.uk](http://www.deykingharia.co.uk)

Tel: 01923 831 020

Watford, 129 The Parade, Watford, Hertfordshire, WD17 1NA

This two bedroom first floor flat is located on the St. Albans Road in North Watford.

The flat comprises an entrance hallway with storage cupboard, a large reception room and separate kitchen, two good sized bedrooms and a modern three piece bathroom.

Other highlights include allocated parking, access to the communal gardens, a secure bike-store and double glazing throughout.

Gladesmere Court is a short walk to North Watford Station and a short drive to the M1, A41 and M25 road links, making it ideal for the busy commuter.

Available mid October on an unfurnished basis.

Key Features:

- + Two Bedrooms
- + Modern Kitchen & Bathroom
- + Allocated Parking





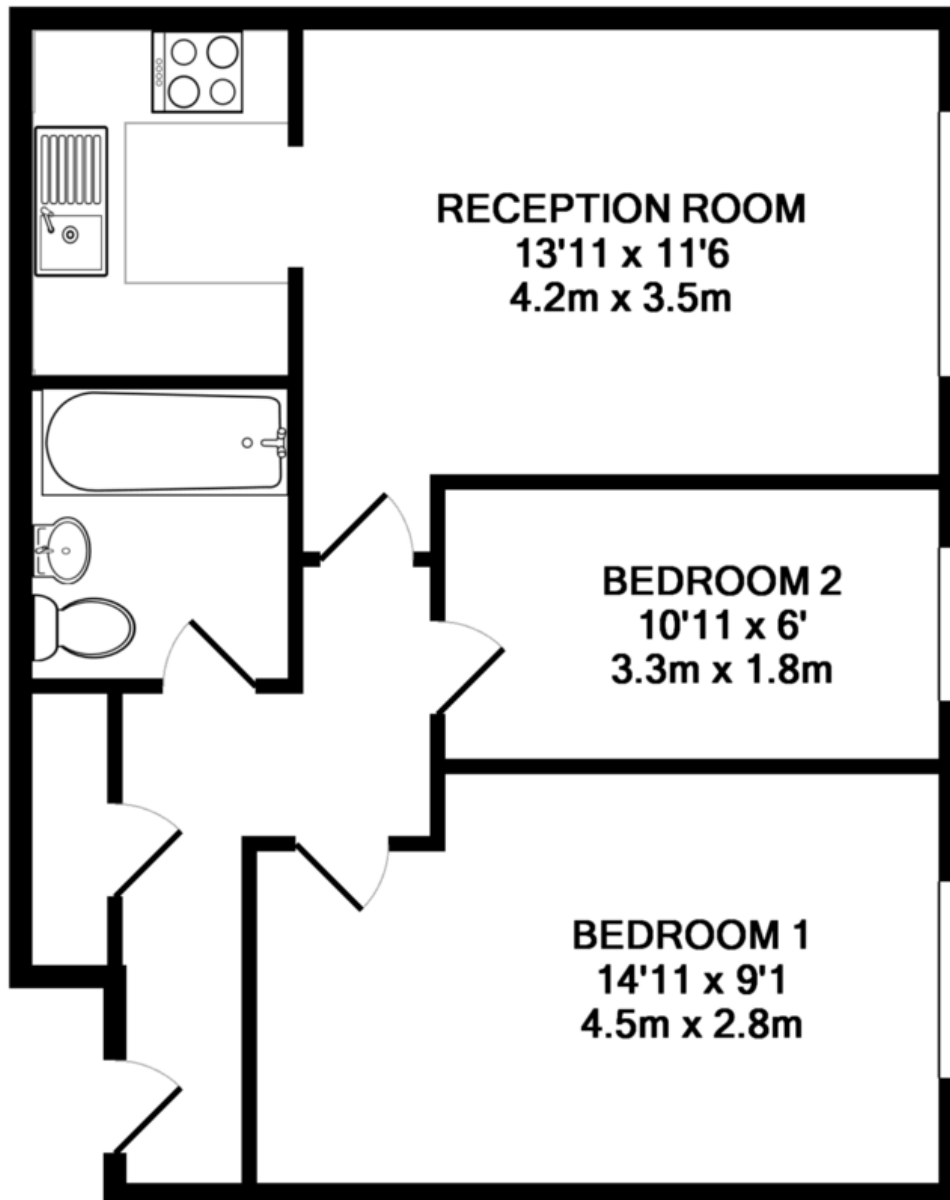

**TOTAL APPROX. FLOOR AREA 484 SQ.FT. (45.0 SQ.M.)**

Whilst every attempt has been made to ensure the accuracy of the floor plan contained here, measurements of doors, windows, rooms and any other items are approximate and no responsibility is taken for any error, omission, or mis-statement. The services, systems and appliances shown have not been tested and no guarantee as to their operability or efficiency can be given. Total floor areas will include any garage(s) where applicable.

Made with Metropix ©2017