



Stroud Green Road, N4 3PZ
£1,400 pcm

**DAVID
ANDREW**

your
most
valuable
asset

Presenting a spacious studio with access to a large communal garden, just 0.5 miles from Finsbury Park Station (Victoria, Northern, and Piccadilly lines). This property is perfect for a single occupant.

Internally the studio has; an abundance of natural light, a modern semi open plan kitchen with brick tiling and a separate private bathroom with shower and bath facilities. Further features include gas central heating, wood flooring and ample storage throughout.

The apartment is located to the rear of the building on Stroud Green Road, 0.5 miles from Finsbury Park tube station (Overground, Victoria & Piccadilly lines). Offered Furnished, Available Now.

Council Tax band: A

EPC Energy Efficiency Rating: D

EPC Environmental Impact Rating: C

- Spacious Studio
- Semi Open Plan
- Access to Communal Garden
- Modern Throughout
- Comprising 300sqft/27.9
- Popular & Convenient Location
- Offered Furnished
- Available Now







Stroud Green Road, N4

Approximate Gross Internal Area = 300 sq ft / 27.9 sq m

**DAVID
ANDREW** | your
most
valuable
asset

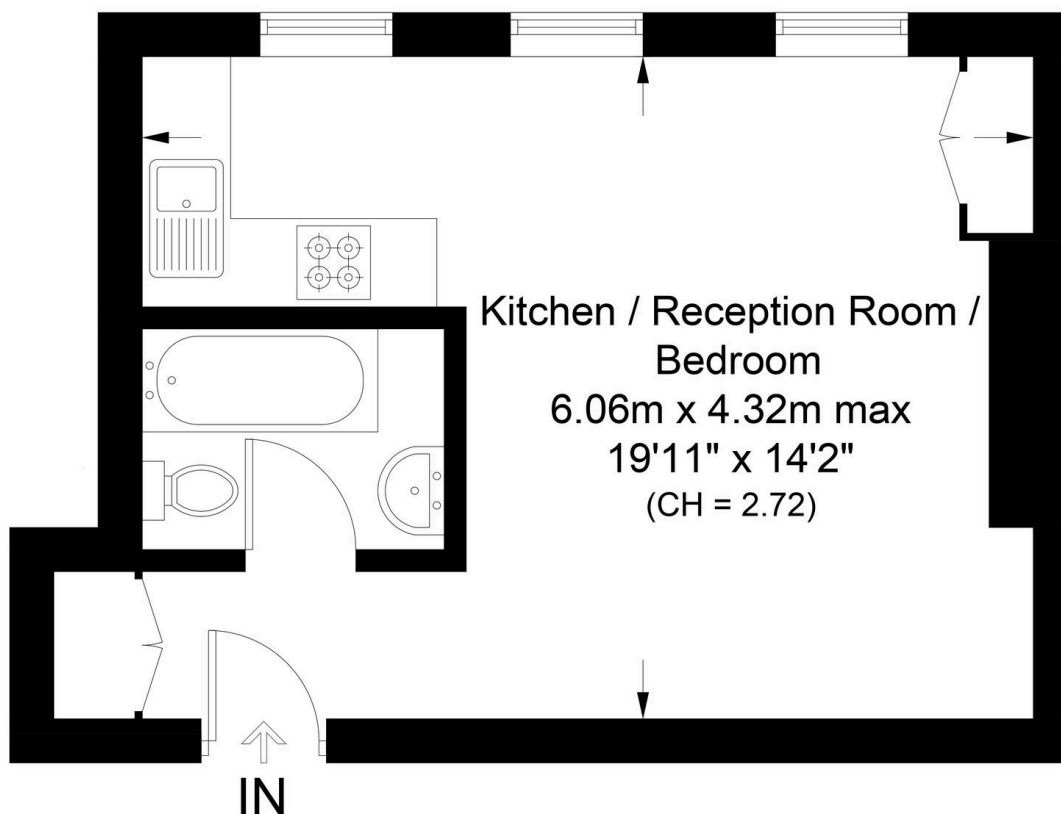

Second Floor

Archway Office

671 Holloway Road
London, N19 5SE

T (0)20 7619 3750

Highbury Office

90 Highbury Park
London, N5 2XE

T (0)20 7354 9111

Finsbury Park Office

167 Stroud Green Road
London, N4 3PZ

T (0)20 7281 2000

Property Management Office

235 Blackstock Road
London, N5 2LL

T (0)20 7354 9222

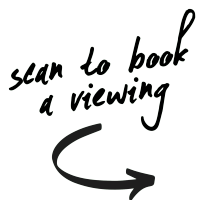

**Certified
Property
Measurer**

This plan is for layout guidance only. Not drawn to scale unless stated. Windows and door openings are approximate. Whilst every care is taken in the preparation of this plan, please check all dimensions, shapes and compass bearings before making any decisions reliant upon them. (ID1114802)

**DAVID
ANDREW** | your
most
valuable
asset

as been exercised in the
of these particulars,
but the property must not be
as representations of
fact. Prospective applicants
and rely upon their own
those of professional
s. David Andrew Estates
liability for any error contained
in these particulars.



safeagent