

RICE+ROMAN



Dial Stone Court, Weybridge

KT13 9DE



Dial Stone Court, Oatlands Avenue, Weybridge, KT13

Approximate Area = 626 sq ft / 58.1 sq m
For identification only - Not to scale

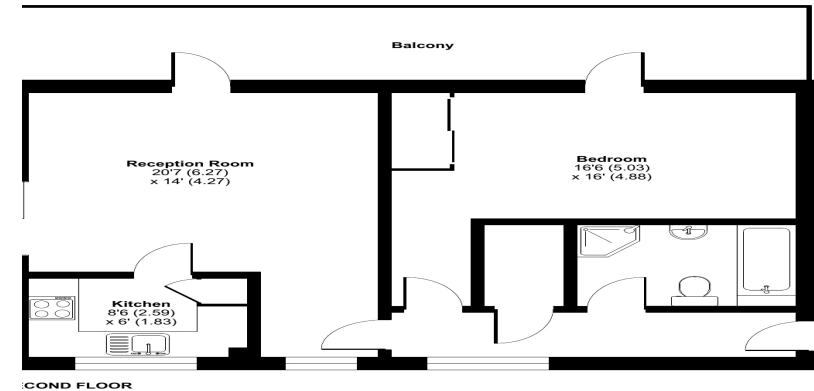

certified property measurer Floor plan produced in accordance with RICS Property Measurement Standards incorporating International Property Measurement Standards (IPMS2 Residential). © riceandroman 2022. Produced for Rice and Roman. REF: 86644

Living Area

Dial Stone Court, Oatlands Avenue, Weybridge, Surrey

- Exclusively For Those Aged 60+
- Top Floor Apartment
- Large Private Terrace
- Lift Access Across All Floors
- Redecorated & Recarpeted throughout
- Development Manager

Price: £225,000

Service Charge: £2,826 PA

Ground Rent: £495 PA

Other Charges: £

Lease Length: 112 years left

Tenure: Leasehold

EPC Rating: C

For more information
please contact:

Rice & Roman
T: 01344 981246
E: info@riceandroman.co.uk
Lynwood Village, SL50FJ
www.riceandroman.co.uk

RICE + ROMAN

Agents Notices - These property details are set out as a general outline only and do not constitute any part of an Offer or Contract. Any services, equipment, fittings or central heating systems have not been tested and no warranty is given or implied that these are in working order. Buyers are advised to obtain verification from their solicitor or surveyor. Fixtures, fittings and other items are not included unless specifically described. All measurements, distances and areas are approximate and for guidance only. Room measurements are taken to be the nearest 10cm and prospective buyers are advised to check these for any particular purpose, e.g. fitted carpets and furniture. This material is protected by the laws of copyright. The owner of the copyright is Countrywide Estate Agents. This property sheet forms part of our database rights and copyright laws. No unauthorised copying or distribution without permission.