



Beechcroft Avenue, Golders Green, NW11

Weekly Rental Of £646



800 finchley road, hampstead garden suburb, london, nw11 7tj

telephone 020 8458 5000 facsimile 020 8209 2068

email sales@litchfields.com web litchfields.com

offices also in highgate

A very spacious two double bedroom ground floor flat in this modern purpose built apartment block. A very short walk to the extensive local amenities of Golders Green with its array of coffee shops, sandwich bars, cafes, restaurants, banks & Golders Green Tube on the Northern Line. There is an allocated parking space for 1 car behind a secure electric gate. Offered unfurnished on a Long Let. EPC = C.

Two Bed Purpose Built Ground Floor Apartment | Reception room | Fully Fitted Kitchen | Two double bedrooms both fitted | Two Bathrooms (1 en-suite) | Wood floors | Very short walk to extensive amenities of Golders Green High Road | Golders Green Tube on the Northern Line is a short walk also | OSP x 1 Car behind secure electronic gate | Unfurnished |



10 Beechcroft (3)

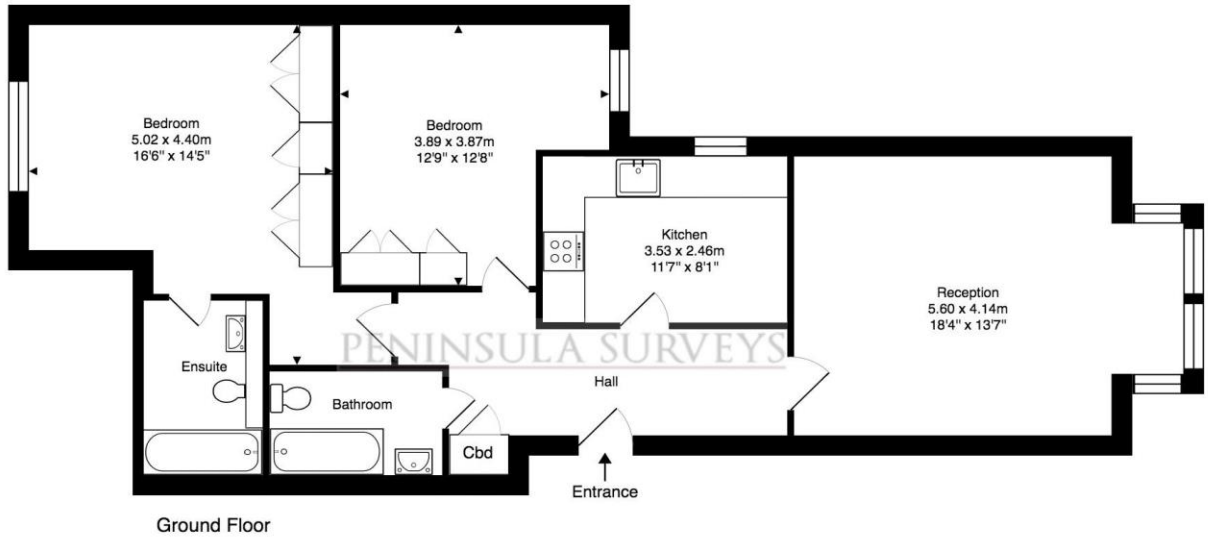

Approx. Gross Internal Area: 81.9 m² ... 882 ft²

All measurements and areas are approximate only.
Dimensions are not to scale. This plan is for guidance
only and must not be relied upon as a statement of fact.
(c) Peninsula Surveys Ltd

PENINSULA SURVEYS