



Lichfield House, Maida Vale Borders, NW6

£429,950

Leasehold



800 finchley road, hampstead garden suburb, london, nw11 7tj

telephone 020 8458 5000 facsimile 020 8209 2068

email sales@litchfields.com web litchfields.com

offices also in crouch end & highgate

On the cusp of Maida Vale and moments away from the underground. A stunning newly built purpose built flat featuring its own magnificent large private terrace. The apartment is presented in excellent condition throughout and ready to move into. This superb block features a concierge and an impressive fully kitted gym. Communal gardens and secure underground parking (subject to permit) along with its fabulous convenient location make this property a fantastic purchase with the advantage that the flat is within the London borough of Westminster. Viewing is strongly recommended. EPC – B.





Large private terrace | Fitted bedroom | Open plan kitchen/reception | Luxury bathroom
Storage/Utility cupboard | Underfloor heating | Secure underground parking (subject to
permit) | Concierge| Moments from underground and shops | Ready to move into | EPC = B

Lichfield House

Approximate Gross Internal Area = 549 sq ft / 51 sq m

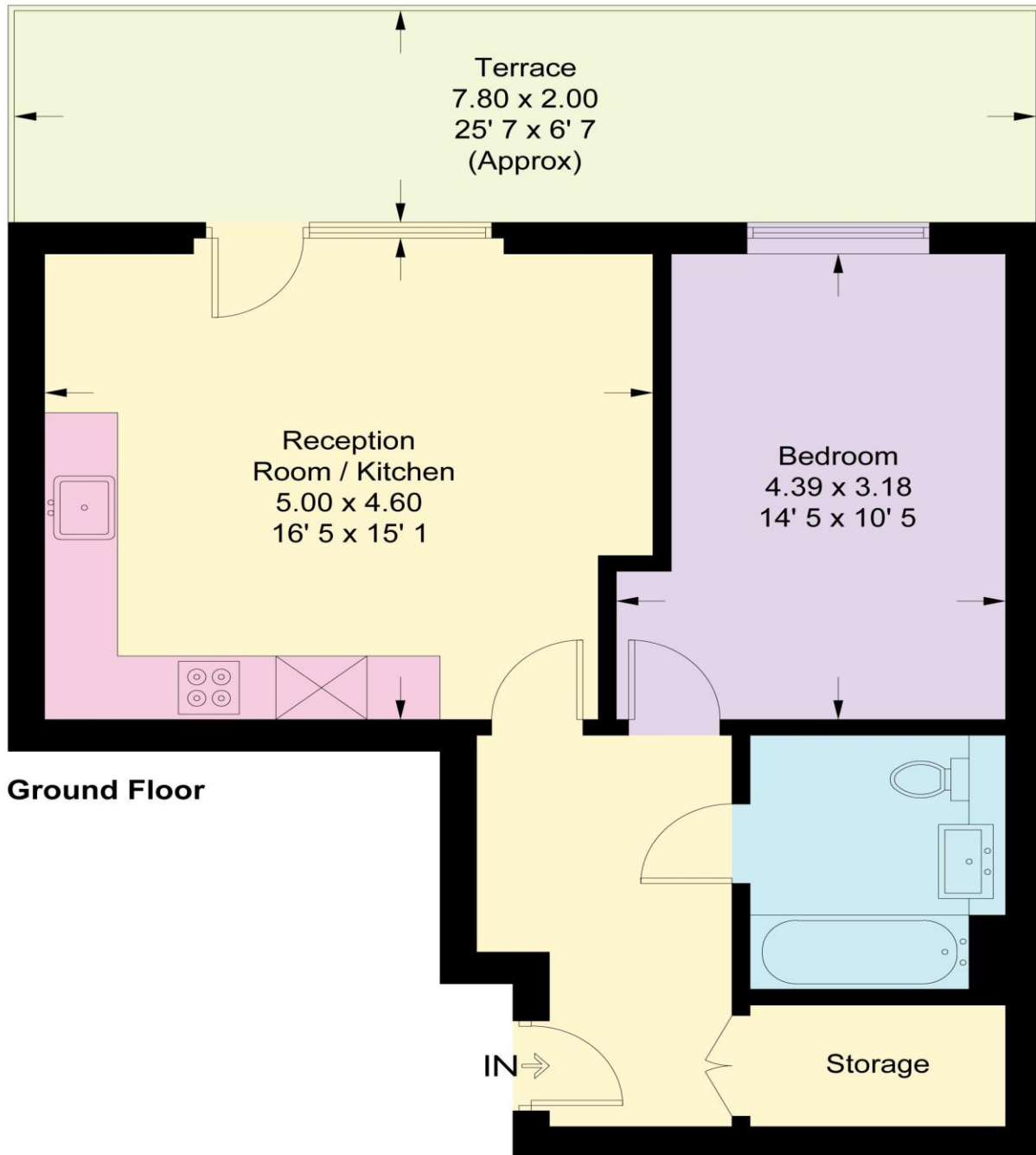

Ground Floor

This plan is not to scale and must be used as layout guidance only. All measurements and areas are approximate and should not be relied upon to provide accurate information. This plan must not be relied upon when making property valuations, design considerations or any other such relevant decisions. We accept no responsibility or liability (whether in contract, tort or otherwise) in relation to any loss whatsoever arising from or in connection with any use of this plan or the adequacy, accuracy or completeness of it or any information within it.