



Beryl Road, W6

£550,000

This well presented two double bedroom, first floor purpose built flat is well located close to Hammersmith Broadway that offers a variety of local amenities. The flat benefits from a long lease and private outside space.

Beryl Road is in a popular location for the extensive amenities and transport links of Hammersmith Broadway and is also within easy reach of the Thames and its array of riverside pubs and eateries.

Features

- Two Double Bedrooms
- One Bathroom
- Long Lease
- Private Outside Space
- Close To Transport
- Hammersmith Station

Beryl Road, London, W6

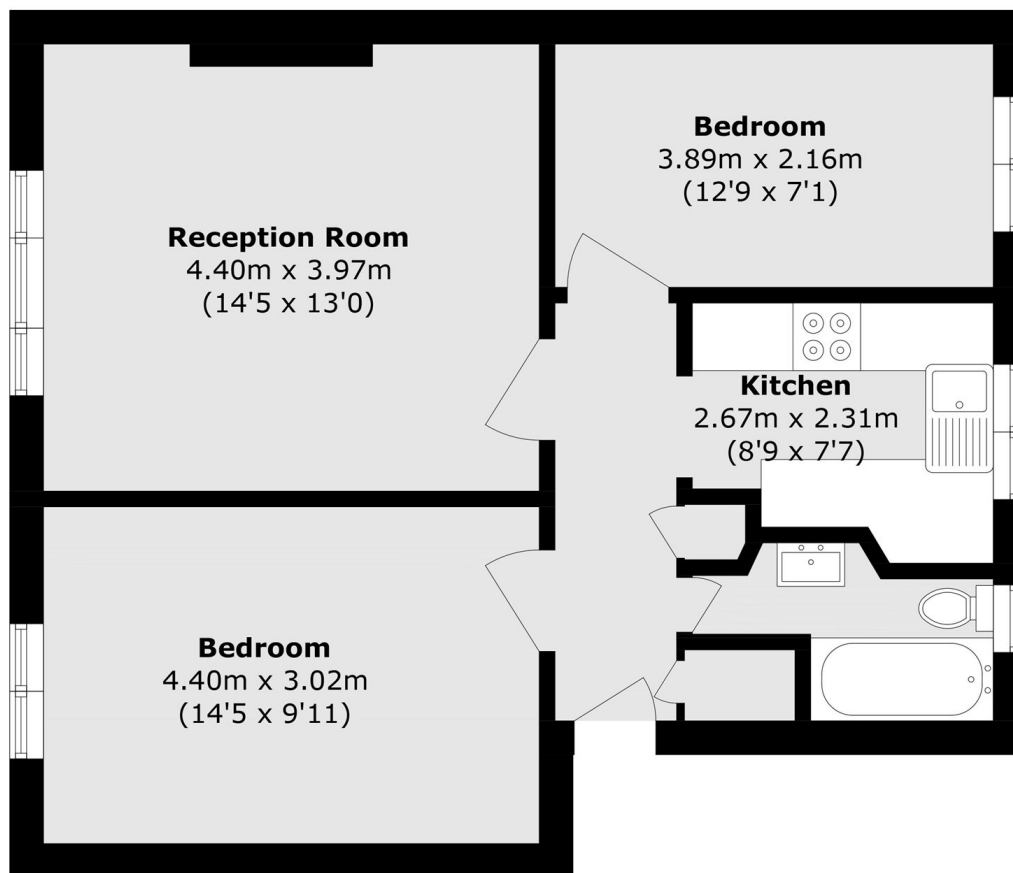

Total area (approx.): 55.4 sq. m (596.3 sq. ft)