



## Hammersmith Grove, W6

£600 Per week

A large and spacious two bedroom garden flat set within a well maintained period property on the desirable Hammersmith Grove. The property comprises of a bright and spacious reception leading out to a substantial private garden and a modern kitchen. There are two double bedrooms, one of which is an en-suite. The flat benefits from an off street parking space.

The property is ideally located within easy reach of Hammersmith Broadway and the popular restaurants on offer on Hammersmith Grove and the Lyric Square.

### Features

- Victorian Garden Flat
- Private Entrance
- Private Garden
- Off-Street Parking
- Modern Kitchen
- Two Double Bedrooms

# Hammersmith Grove, London, W6

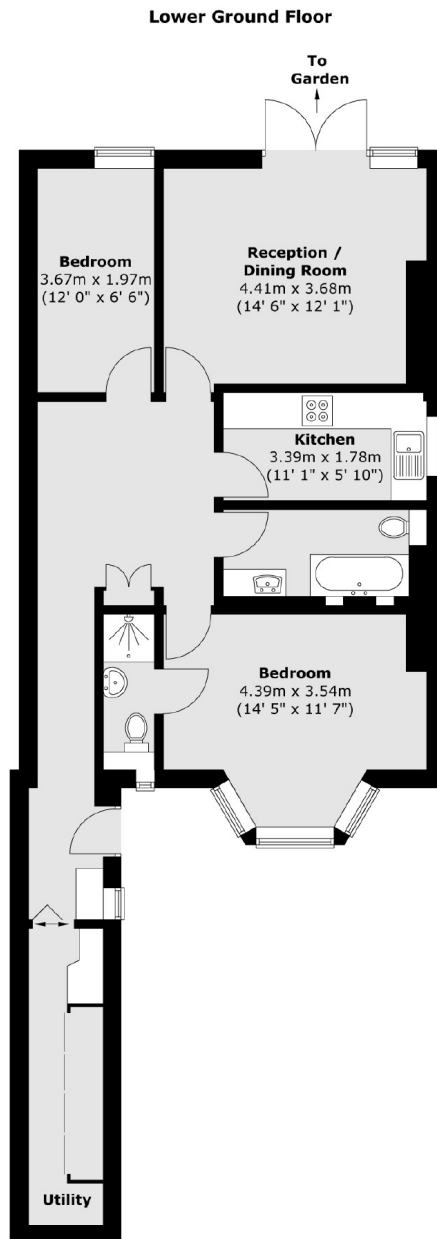

Total area (approx.) : 77 sq. m (829 sq. ft)  
Total patio area (approx.) : 9.1 sq. m (98 sq. ft)