



Ravenscourt Park, W6

£1,000,000

This two bedroom modern built semi detached house is located down a small private gated road just a stones throw away from Ravenscourt Park.

Parkside is located moments away from Ravenscourt Park and Ravenscourt Park station, King Street and Chiswick High road with their many shops, bars and restaurants are just moments away.

Features

- Two Bedrooms
- Semi Detached
- Gated Private Road
- Allocated Off Street Parking
- Patio Garden
- Chain Free



Ravenscourt Park, W6

The ground floor is a fully open plan, kitchen, dining and living space with modern built in appliances, hardwood flooring throughout, skylights above the kitchen maximising natural light as well as a downstairs W.C, utility room and understairs storage, to the front of the property is a private secluded patio garden accessed via crittall french doors from the reception room, there is also an additional storage unit perfect for bikes.

Upstairs you will find two further bedrooms and a modern bathroom, the master bedroom benefits from built in storage and both rooms benefit from air condition, there are three further skylights on this floor to enhance natural light.

The property further benefits from being in a private gated development which is owned and managed by the residents and comes with allocated parking.



Ravenscourt Park, London, W6

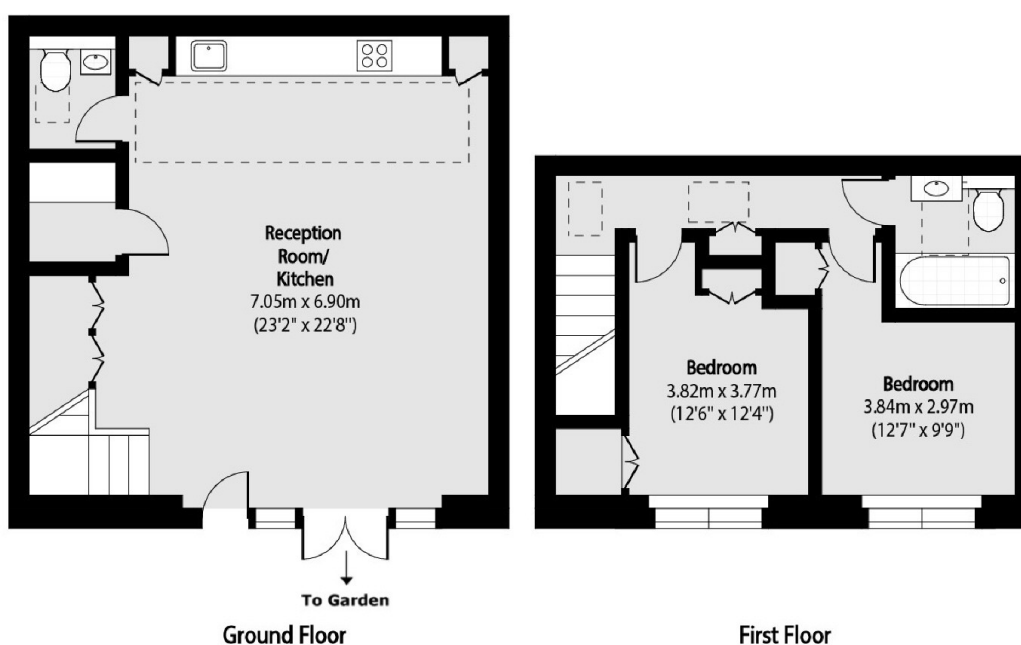

Total area (approx): 81.51 sq m (877 sq. ft)