



## Verbena Gardens, W6

### £625,000

This beautifully presented garden flat has been fully renovated and extended to create a high-quality finish. It has a large open-plan kitchen, dining, and living space that leads to the large landscaped south-facing garden. The property further benefits from custom-made built-in wardrobes in the master bedroom and custom-made storage in the hallway, as well as having a share of the freehold.

Verbena Gardens is well located for the amenities of Chiswick as well as being close by the Hammersmith Riverside with its many riverside walks and pubs. The A4 is close by for easy access to and from the city.

### Features

- Fully Renovated
- Fully Extended
- Custom Made Storage
- High Quality Finish
- Share Of Freehold
- Private South Facing Garden

# Verbena Gardens, London, W6

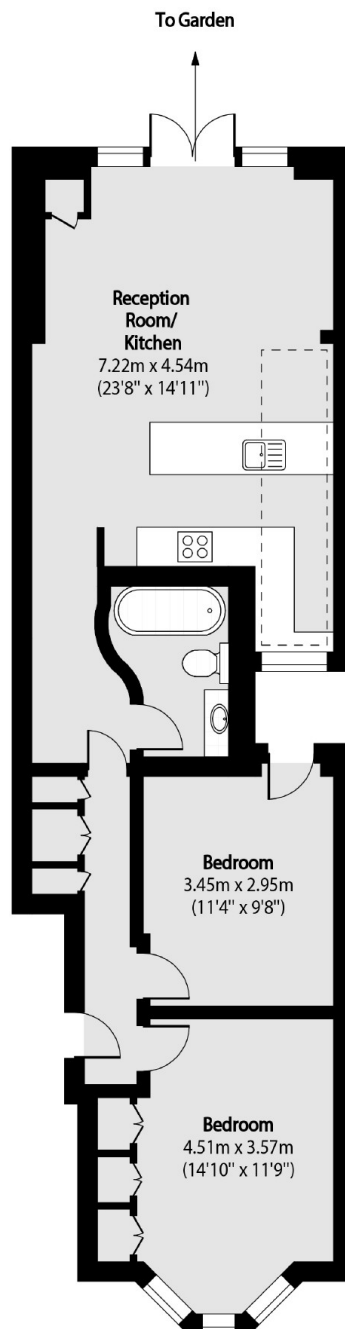

Total area (approx): 69.34 sq m (746 sq. ft)

## Dexters

Hammersmith  
164-166 King Street  
London  
W6 0QU  
Sales  
020 8939 6061

Energy Rating: C. We aim to make our particulars both accurate and reliable. However they are not guaranteed; nor do they form part of an offer or contract. If you require clarification on any points then please contact us, especially if you're traveling some distance to view. Please note that appliances and heating systems have not been tested and therefore no warranties can be given as to their good working order.

 **RICS** | Regulated  
Estate Agent  
and Letting Agent

[dexters.co.uk](https://www.dexters.co.uk)