



Hammersmith Road, W6

£725,000

This spacious flat in a 1930s art-deco purpose built block is located between Hammersmith and Kensington. It offers three double bedrooms, large living spaces alongside the security of being within a gated development with 24 hour concierge.

Latymer Court is situated on the north side of Hammersmith Road, moments away for easy commuter access, from Hammersmith Broadway underground station, with access to four different lines. Amenities are close by on both Kensington High Street and King Street.

Features

- Three Bedrooms
- Gated Development
- Porter/Security
- Good Transport Links
- Hammersmith Broadway
- No Chain

Hammersmith Road, London, W6

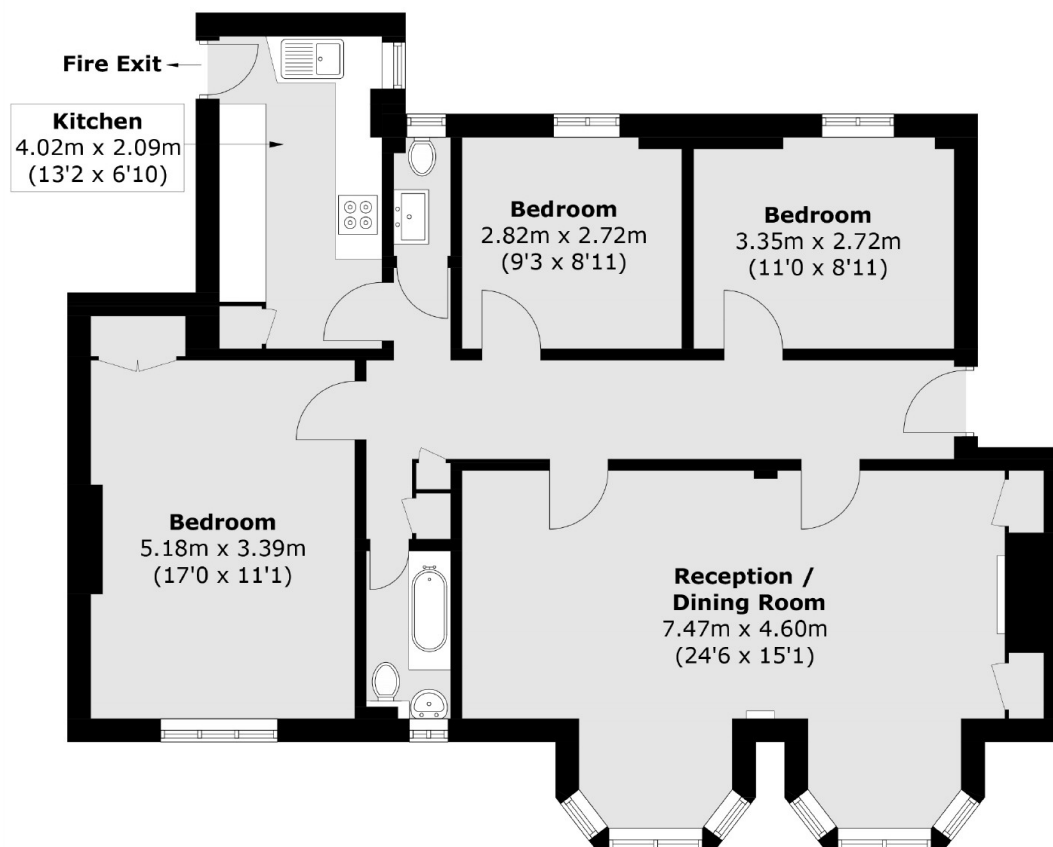

Total area (approx.): 91.0 sq. m (979.5 sq. ft)