



## Crisp Road, W6

£785,000

A stunning one bedroom apartment in the new riverside development Queen's Wharf. The property has a stylish open plan living area with an integrated kitchen, a large master bedroom with en-suit and a private balcony offering garden views.

Queens Wharf residents benefit from a 24-hour dedicated concierge, a rooftop terrace, and an on-site restaurant, bar and café.. Hammersmith station is a short walk away.

### Features

Riverside Development  
One Bedroom Apartment  
Master En Suite  
Open Plan Living Area  
24-hr Concierge  
Winter Garden

# Crisp Road, London, W6

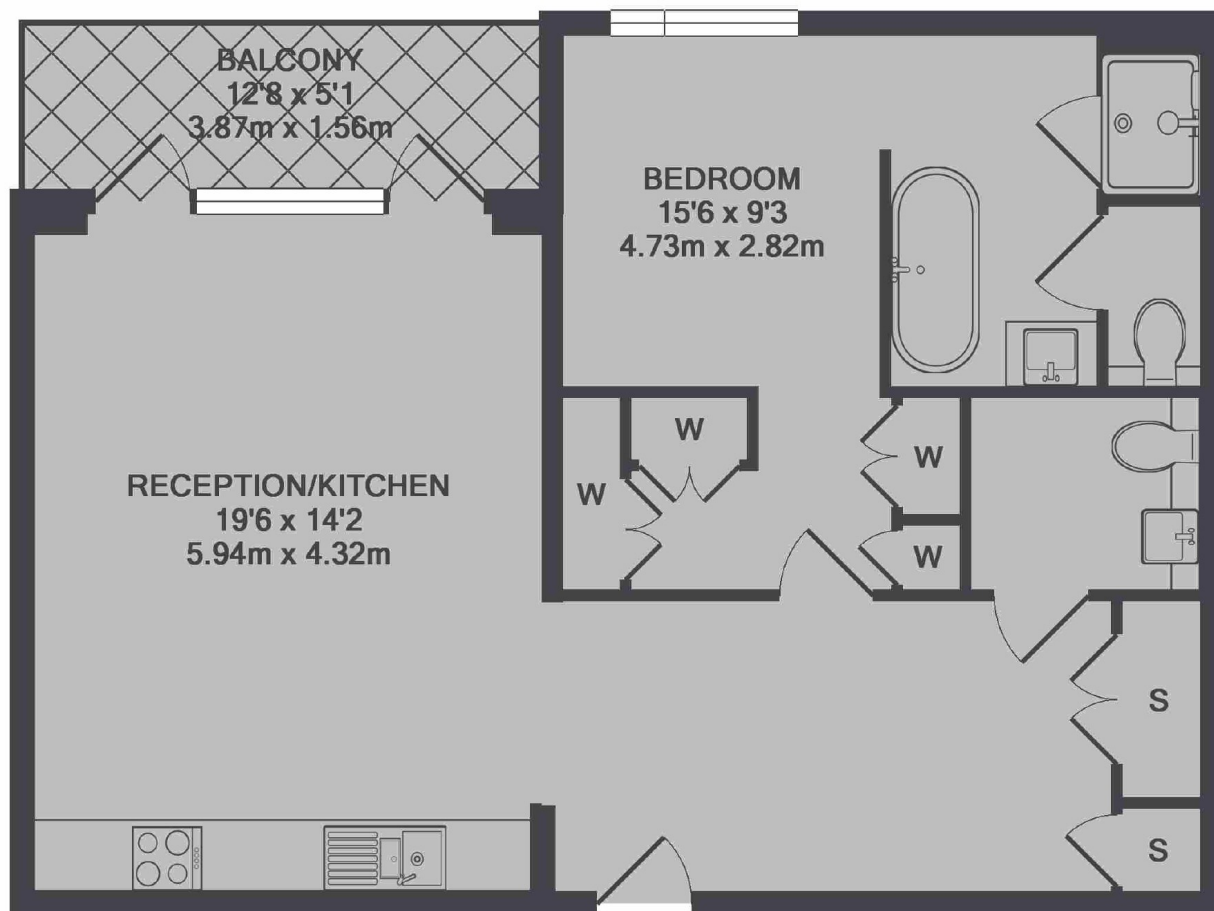

TOTAL APPROX. FLOOR AREA 734 SQ.FT. (68.1 SQ.M.)

## Dexters

Hammersmith  
164-166 King Street  
London  
W6 0QU  
Sales  
020 8939 6061

Energy Rating: B. We aim to make our particulars both accurate and reliable. However they are not guaranteed; nor do they form part of an offer or contract. If you require clarification on any points then please contact us, especially if you're traveling some distance to view. Please note that appliances and heating systems have not been tested and therefore no warranties can be given as to their good working order.

 **RICS** | Regulated  
Estate Agent  
and Letting Agent

[dexters.co.uk](https://www.dexters.co.uk)