



Agate Road, W6

£2,300,000

This sizeable five bedroom Victorian house, spread across four storeys offers the perfect canvass for any buyer looking to create a long lasting family home in the increasingly popular Brackenbury Village.

Agate Road is located in the heart of Brackenbury Village with its popular independent, shops, bars and restaurants as well as the green spaces of Ravenscourt Park and an abundance of transport links.

Features

- Five Bedrooms
- Four Storeys
- Over 2100Sq Feet
- Three Bathrooms
- Further Extension Potential
- STPP
- Brackenbury Village



Agate Road, W6

At over 2100sq feet and across four storeys, this sprawling period house still has further room to extend into the loft STPP and the ground floor to create a stunning family home.

The lower ground floor encompasses the bulk of the living space with two separate reception rooms, storage pantry and a large kitchen dining space which leads out into the garden.

The ground floor offers up flexible living space in the form of two further reception rooms or two bedrooms alongside a second kitchen and bathroom, the top floor offers up four further bedrooms and the third bathroom.



Agate Road, London, W6

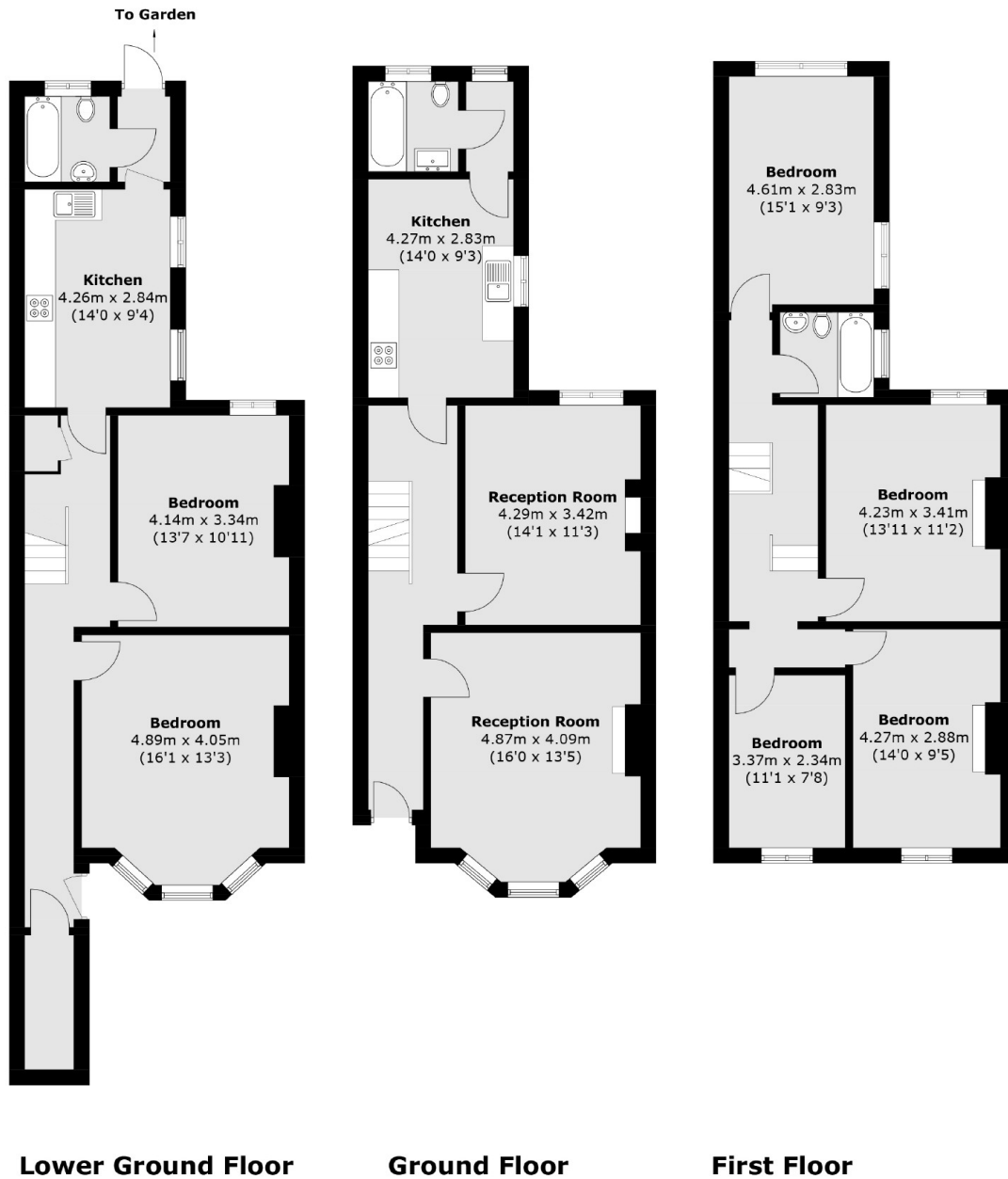

Total area (approx.): 195.6 sq. m (2105.3 sq. ft)