



Margravine Road, W6

£595,000

This attractive and substantial two bedroom flat offers an open plan kitchen living space that leads out to its own private garden. Also benefiting from an additional space that is perfect for a study, it has been renovated to a high standard and would make a wonderful home or investment.

Located near Barons Court and Hammersmith stations, Margravine Road benefits from a variety of great transport links including tube and bus routes. There are a variety of boutique shops, bars and eateries and is walking distance to the river Thames.

Features

- Well Presented
- Two Double Bedrooms
- One Bathroom
- Private Garden
- Open Plan
- Barons Court

Margravine Road, London, W6

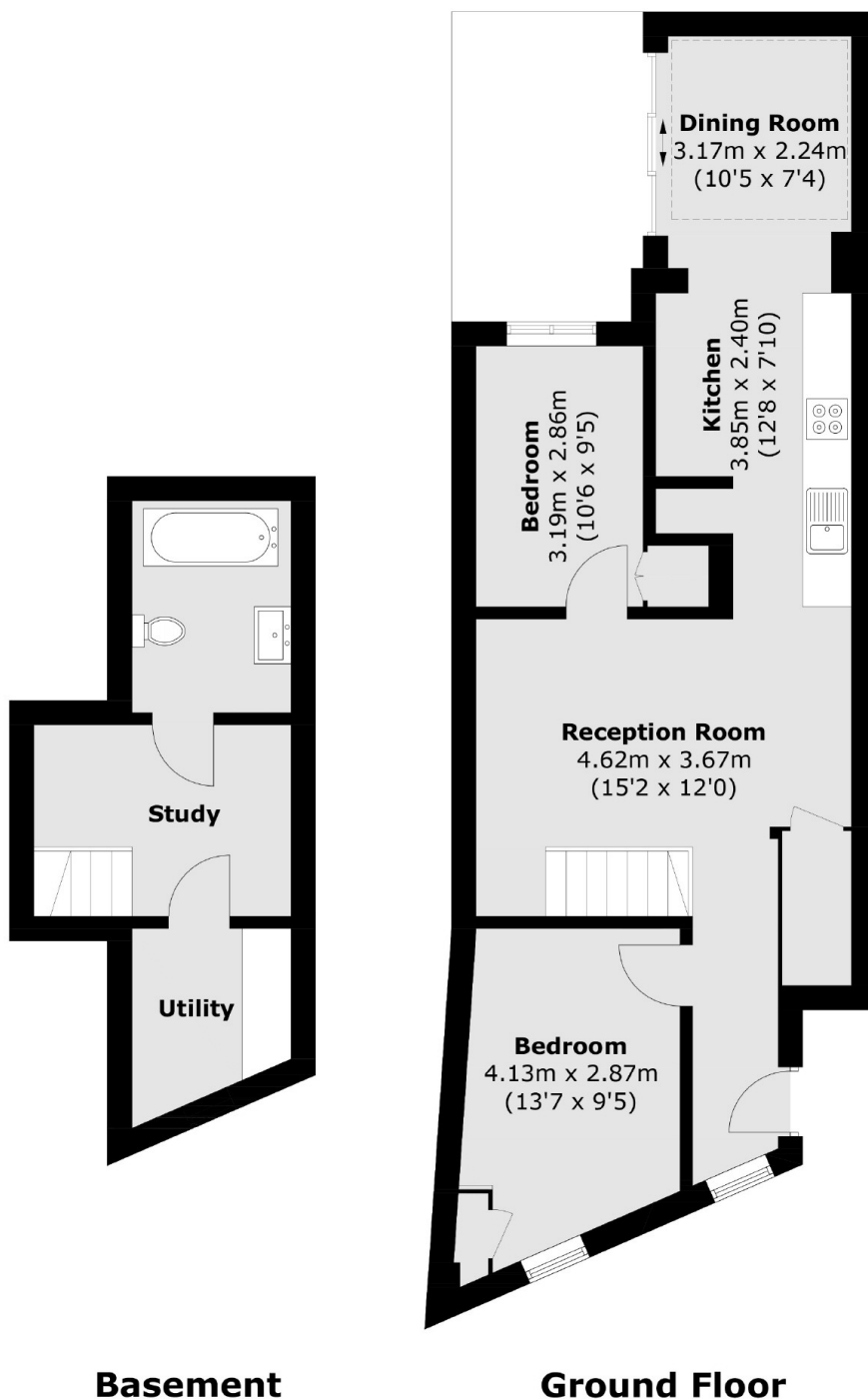

Basement

Ground Floor

Total area (approx.): 73.2 sq. m (787.8 sq. ft)

Dexters

Hammersmith
164-166 King Street
London
W6 0QU
Sales
020 8939 6061

Energy Rating: D. We aim to make our particulars both accurate and reliable. However they are not guaranteed; nor do they form part of an offer or contract. If you require clarification on any points then please contact us, especially if you're traveling some distance to view. Please note that appliances and heating systems have not been tested and therefore no warranties can be given as to their good working order.

 **RICS** | Regulated
Estate Agent
and Letting Agent

[dexters.co.uk](https://www.dexters.co.uk)