



Down Place, W6

£450,000

An immaculately presented two bedroom, two bathroom apartment perfectly located in the heart of Hammersmith. This property would make a wonderful home or investment.

Tucked away between King Street and the Riverside, with plenty of amenities to enjoy as well as the popular Thames Path. Hammersmith Broadway and A4/M4 access make it perfect for commuters.

Features

- Two Bedrooms
- Two Bathrooms
- Own Entrance
- Concierge
- Lift
- Hammersmith Broadway

Down Place, London, W6

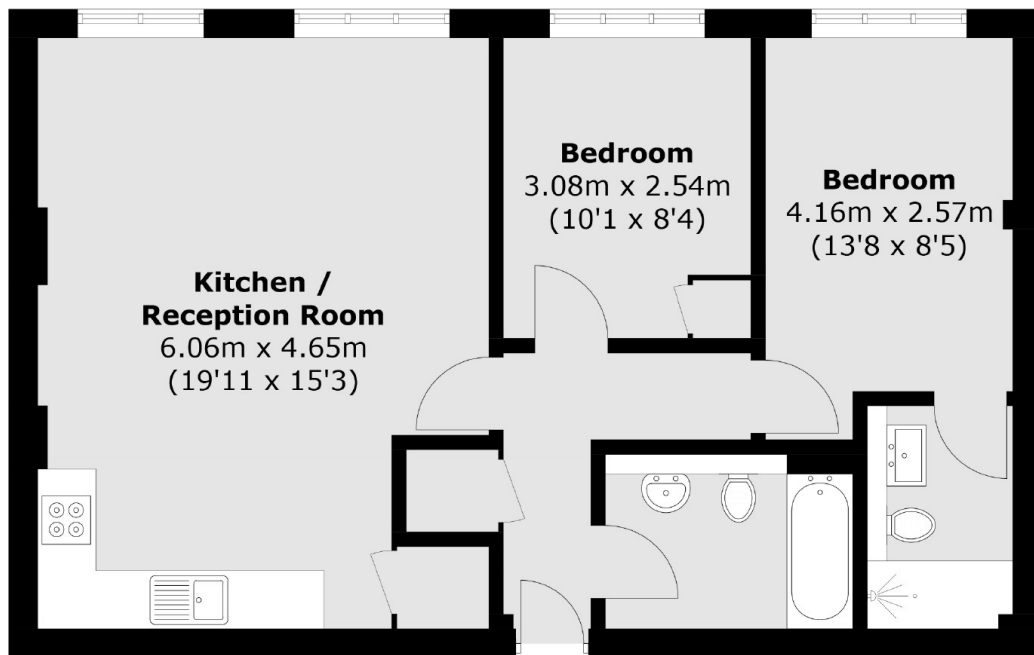

Total area (approx.): 61.4 sq. m (660.9 sq. ft)