

C&R

Commercial & Residential

Properties

£140,000

Richmond Court, Salford, M3 6DW



2

Bedrooms



1

Bathroom

Citypoint 2, 156 Chapel Street, , Manchester, M3 6BF |
enquiries@candrproperties.co.uk

0161 227 9990



Offered to the market with no onward chain & sold as seen. C & R City are pleased to bring to the market a spacious two bedroom second floor flat located on Richmond Court, Salford, M3. Richmond Court occupies a convenient location close to Adelphi Street and is within walking distance to the city centre, Spinningfields & Salford University. The property comprises of an entrance hall, spacious open plan living area with double height ceiling, fitted kitchen with storage, two double bedrooms and a four piece bathroom suite. Early viewing comes highly recommended!

All services/appliances have not and will not be tested.

Offered to the market with no onward chain & sold as seen. C & R City are pleased to bring to the market a spacious two bedroom second floor flat located on Richmond Court, Salford, M3. Richmond Court occupies a convenient location close to Adelphi Street and is within walking distance to the city centre, Spinningfields & Salford University. The property comprises of an entrance hall, spacious open plan living area with double height ceiling, fitted kitchen with storage, two double bedrooms and a four piece bathroom suite. Early viewing comes highly recommended!

All services/appliances have not and will not be tested.

Lounge 7.01m x 6.92m (23' x 22' 8")

Master Bedroom 4.46m x 2.97m (14' 8" x 9' 9")

Bedroom Two 3.20m x 2.56m (10' 6" x 8' 5")

Bathroom Suite 2.02m x 2.42m (6' 8" x 7' 11")

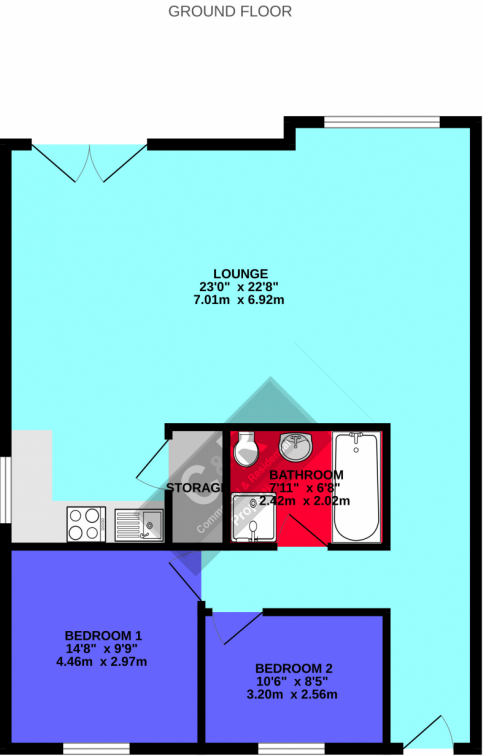

C & R PROPERTIES

Whilst every attempt has been made to ensure the accuracy of the footprint contained here, measurements of doors, windows, rooms and any other items are approximate and no responsibility is taken for any error, omission or mis-statement. This plan is for illustrative purposes only and should be used as such by any prospective purchaser. The services, systems and appliances shown have not been tested and no guarantee as to their operability or efficiency can be given.
Made with Metagage C2D25

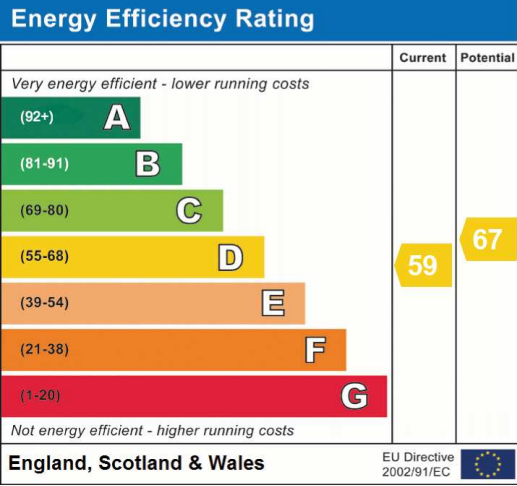

Address: Richmond Court, Salford, M3 6DW

