

C&R

Commercial & Residential

Properties

£190,000

Advent 1, Isaac Way, Manchester, M4 7EF



2

Bedrooms



2

Bathrooms

Citypoint 2, 156 Chapel Street, , Manchester, M3 6BF |
enquiries@candrproperties.co.uk

0161 227 9990 



Offered to the market with no onward chain. C & R City are pleased to bring to the market this well presented and spacious two-bedroom apartment located in Isaac Way, Manchester, M4. This apartment gives a spacious & light feeling throughout and comprises; a spacious open plan living/dining room area with open plan fully fitted kitchen. There is also a Juliet balcony with large floor to ceiling sliding doors in the living room which allows good amounts of natural light. There are two double bedrooms, also with floor to ceiling sliding doors, the master bedroom boasts an en-suite shower/wet room. The main bathroom is spacious and offers a three-piece suite. The apartment is well positioned within walking distance of New Islington Metrolink Station and Manchester City Centre.

Offered to the market with no onward chain. C & R City are pleased to bring to the market this well presented and spacious two-bedroom apartment located in Isaac Way, Manchester, M4. This apartment gives a spacious & light feeling throughout and comprises; a spacious open plan living/dining room area with open plan fully fitted kitchen. There is also a Juliet balcony with large floor to ceiling sliding doors in the living room which allows good amounts of natural light. There are two double bedrooms, also with floor to ceiling sliding doors, the master bedroom boasts an en-suite shower/wet room. The main bathroom is spacious and offers a three-piece suite. The apartment is well positioned within walking distance of New Islington Metrolink Station and Manchester City Centre.

Hallway 3.16m x 1.73m (10' 4" x 5' 8")

Lounge 7.31m x 3.47m (NaN' NaN" x 11' 5")

Bedroom One 5.06m x 2.63m (16' 7" x 8' 8")

Bedroom Two 4.02m x 2.64m (13' 2" x 8' 8")

Bathroom 1.97m x 2.63m (6' 6" x 8' 8")

General Information

Lease 250 years from 1st of April 2003. Ground rent: £150 PA. Service charge: Approx £658 per quarter. Council Tax Band C. EPC Rating: D.

GROUND FLOOR

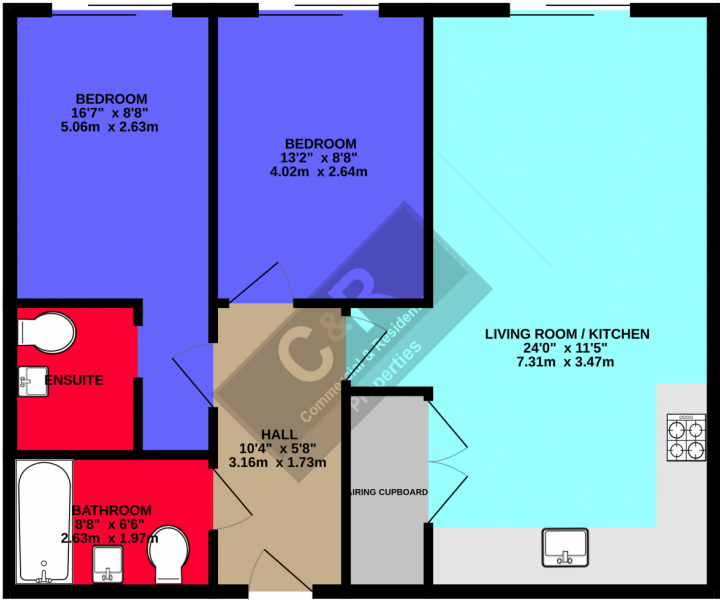

APARTMENT 238 ADVENT WAY, ISAAC WAY, MANCHESTER, M4 7EF

While every attempt has been made to ensure the accuracy of the floorplan contained here, measurements of doors, windows, rooms and any other items are approximate and no responsibility is taken for any error, omission or mis-statement. This plan is for illustrative purposes only and should be used as such by any prospective purchaser. The fixtures, systems and appliances shown have not been tested and no guarantee as to their operability or efficiency can be given.
Made with Metrepro 12/2024

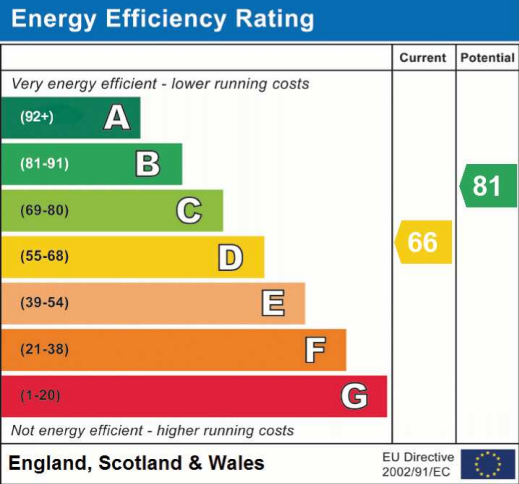

Address: Advent 1, Isaac Way, Manchester, M4 7EF

