



 0
Bedroom

 0
Bathroom



****Available Now**** C & R City are pleased to bring to the market a spacious and well presented first floor office space measuring at approx 1115 sqft (103.5 sq.m). The property comprises of a spacious open plan office, modern kitchen, modern shower room and 2 x meeting rooms. The office space has the added benefit of two parking spaces. Varley Business Centre is located at the junction of Varley Street and James Street in the Miles Platting area of East Manchester, approximately 1 miles (1.6 km) east of Manchester City Centre.

Please note, VAT is applicable on the rent.

****Available Now**** C & R City are pleased to bring to the market a spacious and well presented first floor office space measuring at approx 1115 sqft (103.5 sq.m). The property comprises of a spacious open plan office, modern kitchen, modern shower room and 2 x meeting rooms. The office space has the added benefit of two parking spaces. Varley Business Centre is located at the junction of Varley Street and James Street in the Miles Platting area of East Manchester, approximately 1 mile (1.6 km) east of Manchester City Centre.

Please note, VAT is applicable on the rent.

Office 10.53m x 6.92m (34' 7" x 22' 8")

Office Space 2.90m x 2.24m (9' 6" x 7' 4")

Office Space 2.99m x 2.90m (9' 10" x 9' 6")

Kitchen 2.90m x 3.83m (9' 6" x 12' 7")

GROUND FLOOR
1115 sq.ft. (103.5 sq.m.) approx.

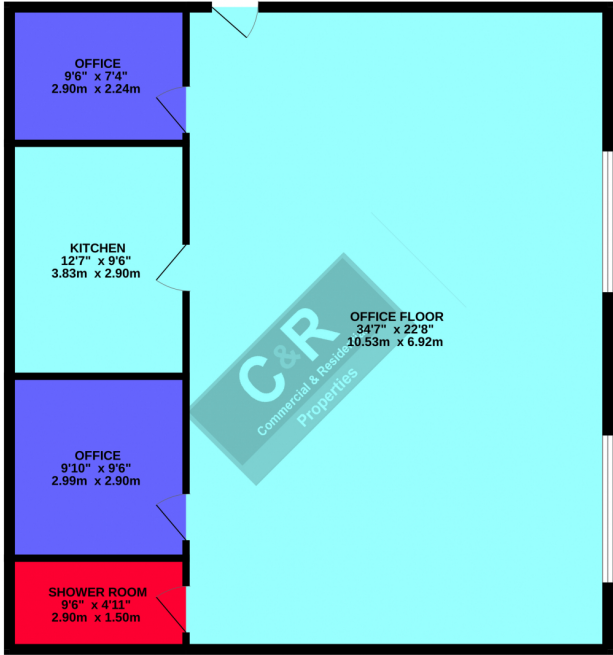

C & R PROPERTIES
TOTAL FLOOR AREA: 1115 sq.ft. (103.5 sq.m.) approx.
While every attempt has been made to ensure the accuracy of the floorplan contained here, measurements of doors, windows, rooms and any other items are approximate and no responsibility is taken for any error, omission or mis-statement. This plan is for illustrative purposes only and should be used as such by any prospective purchaser. The services, systems and appliances shown have not been tested and no guarantee as to their operability or efficiency can be given.
Made with Metropix 52024

Energy Performance Asset Rating

