



 1
Bedroom

 1
Bathroom



C & R Properties are now in receipt of an offer for the sum of £170,000 for (Flat A, 4-5 Watson St, Manchester M3 4EE. Anyone wishing to place an offer on this property should contact C & R Properties, City Point 2, 156 Chapel St, M3 6ES, 0161 227 9990 Option 1, before exchange of contracts

Offered to the market with no onward chain. market a well presented one bedroom apartment situated in Great Northern Tower. The property comprises of an open plan living area and kitchen with integrated appliances, a private balcony, spacious bedroom and a three piece bathroom suite. The apartment has the added benefit of a 24/7 concierge service. Great Northern Tower is a 72 meter sloped residential development which is set back just off Deansgate.

Location: Great Northern Tower is located just off Deansgate offering easy access to St Peter's Square and Spinningfields. The apartment is also a short stroll from an array of shops, bars and restaurants there is

C & R Properties are now in receipt of an offer for the sum of £170,000 for Flat A, 4-5 Watson St, Manchester M3 4EE. Anyone wishing to place an offer on this property should contact C & R Properties, City Point 2, 156 Chapel St, M3 6ES, 0161 227 9990 Option 1, before exchange of contracts

Offered to the market with no onward chain. C & R City are pleased to bring to the market a well presented one bedroom apartment situated in Great Northern Tower. The property comprises of an open plan living area and kitchen with integrated appliances, a private balcony, spacious bedroom and a three piece bathroom suite. The apartment has the added benefit of a 24/7 concierge service. Great Northern Tower is a 72 meter sloped residential development which is set back just off Deansgate.

Location: Great Northern Tower is located just off Deansgate offering easy access to St Peter's Square and Spinningfields. The apartment is also a short stroll from an array of shops, bars and restaurants there is also numerous transport links giving access to all corners of the city and beyond.

Ground Rent: £100Pa

Service Charge: £2313.05

GROUND FLOOR

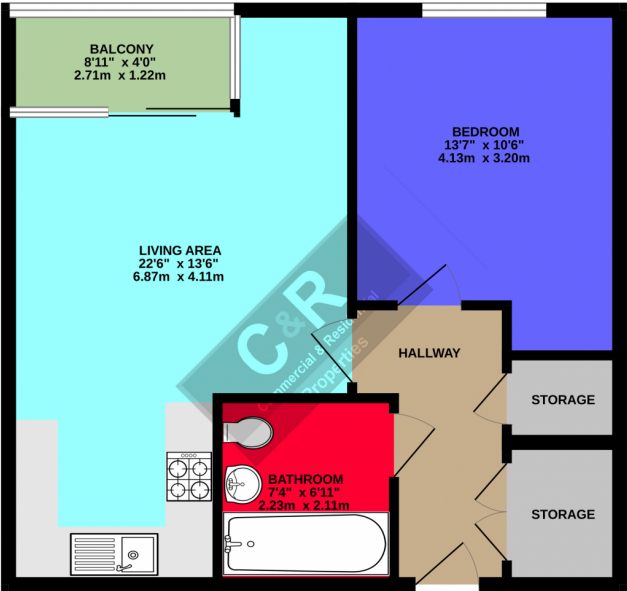

C & R PROPERTIES

While every attempt has been made to ensure the accuracy of the floorplan contained here, measurements of doors, windows, rooms and any other items are approximate and no responsibility is taken for any error, omission or mis-statement. This plan is for illustrative purposes only and should be used as such by any prospective purchaser. The services, systems and appliances shown have not been tested and no guarantee as to their operability or efficiency can be given.
Made with Metagon ©2023

Energy Efficiency Rating		
	Current	Potential
Very energy efficient - lower running costs		
(92+) A		
(81-91) B		85
(69-80) C	78	
(55-68) D		
(39-54) E		
(21-38) F		
(1-20) G		
Not energy efficient - higher running costs		
England, Scotland & Wales	EU Directive 2002/91/EC 	

Address: Great Northern Tower, Watson Street, Manchester, M3 4

