

LCP/PrivateOffice

est.1990

Rochester Row, Westminster SW1P
Asking Price £695,000 STC



Description

Situated on the third floor (with lift) of a modern portered block in Westminster, this one bedroom flat provides generous accommodation and secure underground parking.

There is a spacious open plan kitchen / reception room with plenty of space for dining. The bedroom has fitted wardrobes and there is a modern bathroom. The underground parking is currently let for £190pcm.

Rochester Row is well placed for national travel links from Victoria Station, its proximity to Westminster and the Houses of Parliament and local shopping including Tachbrook Market.



Accommodation

3rd Floor Apartment | Lift | Open Plan Kitchen / Reception Room | Bedroom | Fitted Cupboards | Porter | Underground Parking | 574 sq ft (53 sq m)

Asking Price	£695,000 STC
Lease	116 years remaining
Service Charge	£14,226 per annum (inc. major works)
Ground Rent	Peppercorn
Council Tax	Westminster Band E



ROCHESTER ROW, SW1

Approx. gross internal area

574 Sq Ft. / 53.4 Sq M.

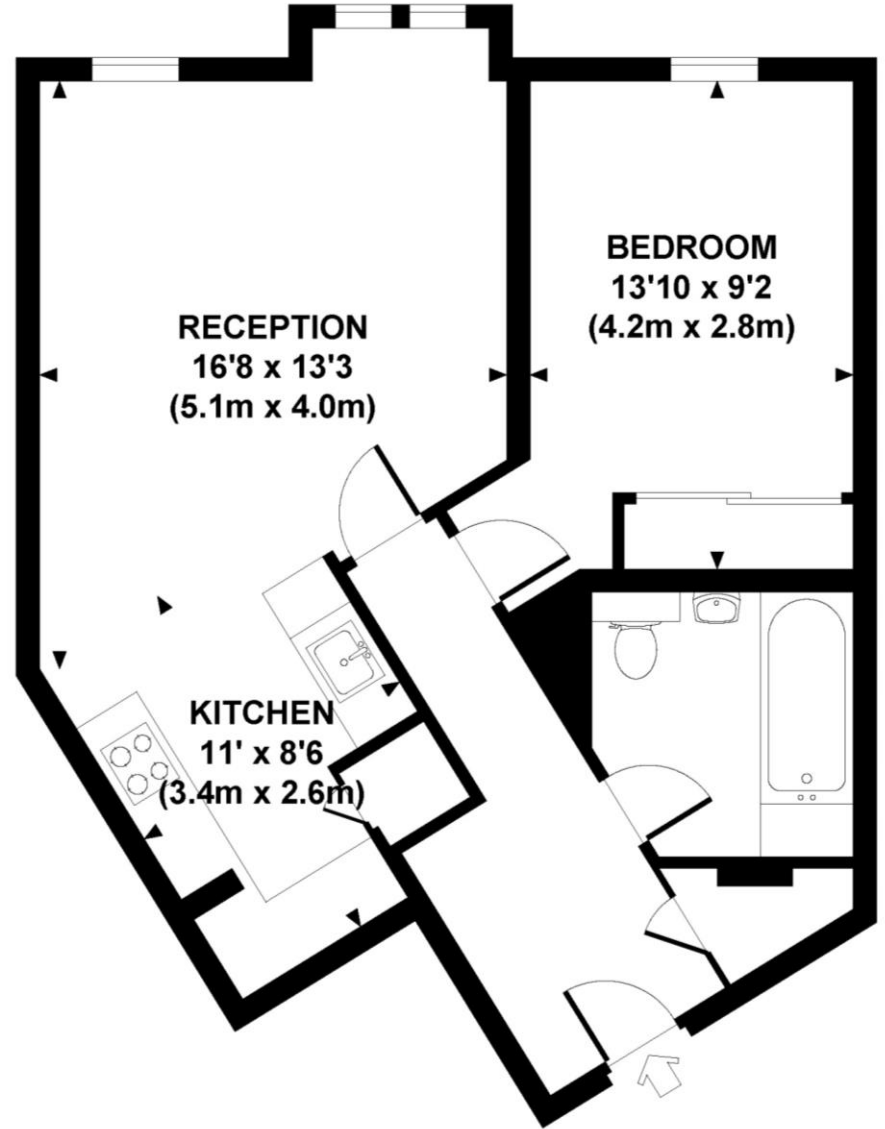
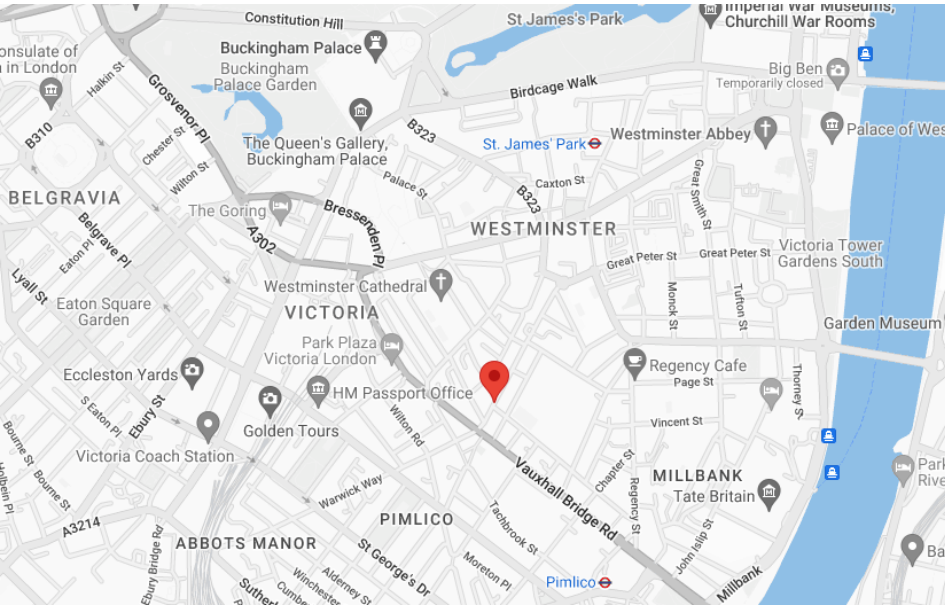

THIRD FLOOR

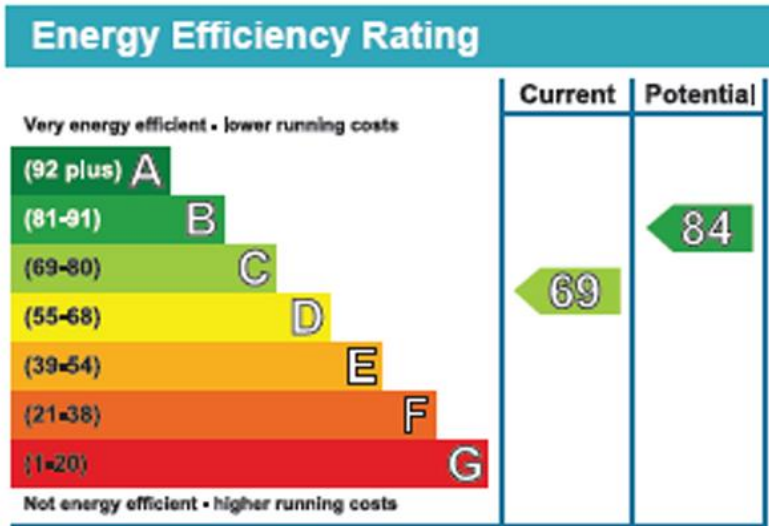

Please note none of the statements contained in these particulars as to this property are to be relied on as statements or representation of fact. It should also be noted that amenities and appliances have not been tested.



All measurements are approximate and for illustration purposes only as defined by the RICS Code of Measuring Practice © 2014 Dowling Jones Design www.dowlingjones.com 020 7610 9933



LCP House, Ogle Street, London W1W 6HU
sales@lcprivate.com
020 7723 1733





LCP House, Ogle Street, London W1W 6HU
sales@lcpprivate.com
020 7723 1733

LCP/PrivateOffice

est.1990

LCP House, Ogle Street, London W1W 6HU
sales@lcprivate.com
020 7723 1733