

TO LET

Somerset Waye, Heston, TW5 9HF
£2,600 Per Calendar Month

DBK
ESTATE AGENTS

- Available To Rent Immediately!
- Extended Semi-Detached Property
- Four Bedrooms
- Through Lounge
- Extended Kitchen/ Diner
- Family Bathroom Suite
- Ground Floor WC
- Large Rear Garden
- Front Garden with Off Street Parking
- Circa 1,134 Sq.Ft

THE PROPERTY

Spacious and Extended Four-Bedroom Semi-Detached Home. Available To Rent Immediately!

This well-presented semi-detached property offers generous living space ideal for families. The first floor comprises three well-proportioned bedrooms and a family bathroom suite. In addition, the home features a bright and spacious through lounge, an extended kitchen and dining, bedroom four and a convenient ground floor WC.

Externally, the property boasts a large rear garden, perfect for outdoor enjoyment, while the front garden provides off-street parking for added convenience.

This property is sited moments away from excellent nearby transport links such as Hounslow West Underground Station connecting commuters to The City as well as local bus links providing transport to neighbouring towns and Heathrow Airport. Furthermore, it is conveniently located to an array of local amenities. For motorists the A4/M4 can be found within proximity. Reputable schools such Springwell School, Heston Community School, Berkeley Academy and Westbrook Primary can be found nearby.

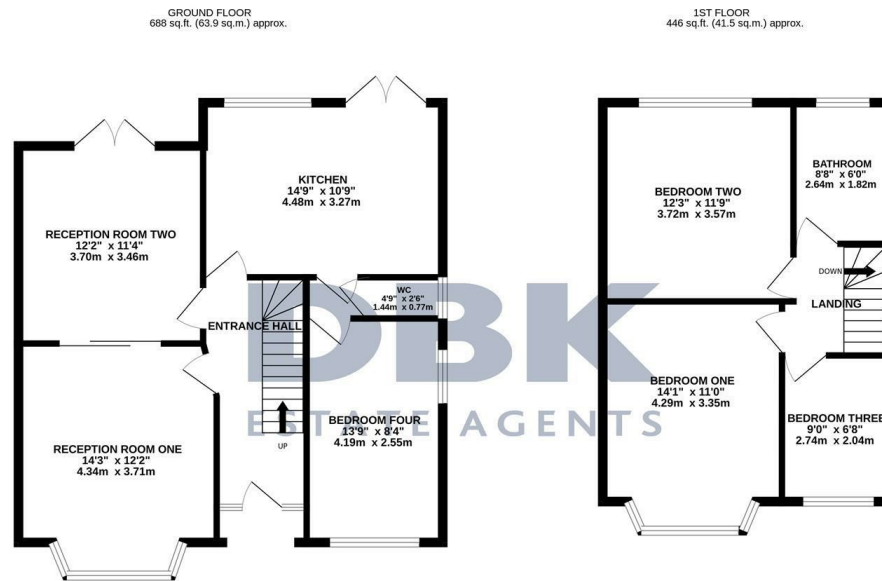

TOTAL FLOOR AREA: 1134 sq.ft. (105.4 sq.m.) approx.

Whilst every attempt has been made to ensure the accuracy of the floorplan contained here, measurements of doors, windows, rooms and any other items are approximate and no responsibility is taken for any error, omission or mis-statement. This plan is for illustrative purposes only and should be used as such by any prospective purchaser. The services, systems and appliances shown have not been tested and no guarantee as to their operability or efficiency can be given.
Made with Metropix ©2025