



TO LET

Coppice Drive, Staines-Upon-Thames, TW19 5JG
£2,700 Per Calendar Month

DBK
ESTATE AGENTS

- Available To Rent Immediately!
- Stunning Detached Bungalow
- Four Sizeable Bedrooms
- Two Reception Rooms
- Modern Fitted Kitchen/ Diner
- Two Family Bathrooms/ WC & One Ensuite
- Enormous Garden
- Off- Street Parking For Several
- St John's Beaumont School 0.6 miles
- Wraysbury Station 1.1 miles

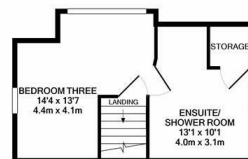
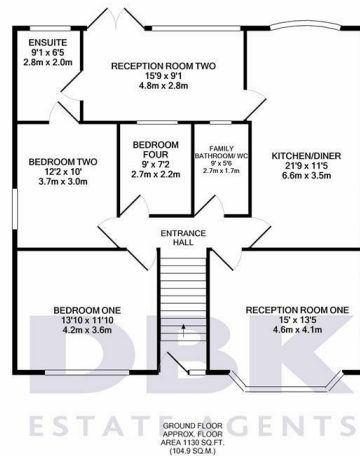

TOTAL APPROX. FLOOR AREA 1435 SQ.FT. (133.3 SQ.M.)

Whilst every effort has been made to ensure the accuracy of the floor plan contained here, measurements of doors, windows, rooms and any other items are approximate and no responsibility is taken for any error, omission, or mis-statement. This plan is for illustrative purposes only and should be used as such for any prospective purchaser. The services, systems and appliances shown have not been tested and no guarantee as to their operability or efficiency can be given.

Made with Metropix 12/21

THE PROPERTY

Available To Rent Immediately!

A stunning double fronted detached bungalow situated on a prime road in the heart of Wraysbury Village. Accommodation boasts Four sizeable bedrooms (Two with ensembles), Two reception rooms, a large modern fitted kitchen/ diner and a chic family bathroom/ wc. Supplementary to this is an enormous rear garden, off-street parking for several cars and fitted wardrobes.

Sited on this prominent residential road the property lays within close proximity to local amenities including Co-Op Food as well being located close by to Windsor and Staines providing ample retail and leisure services. For motorists the M25, M3 and M4 provides links to neighbouring towns and for those commuting to The City, Wraysbury Station is 1.1 mile from the property. Local Reputable schools include Wraysbury Primary School, St John's Beaumont School and St Peter's Church of England Middle School.