



Apartment

# APART 8, NEW MOON APARTMENTS SHIRE OAK ROAD, HEADINGLEY,

Per Week

## £250 Per

FEATURES

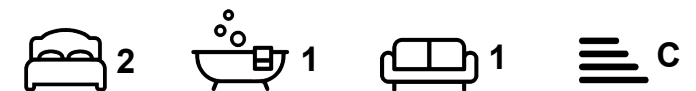

**SJM** ©  
**PROPERTIES**

# 2 Bedroom Apartment located in Leeds

Nestled within its own grounds and secured by electric gates, this exquisite apartment offers a blend of modern comfort and convenience in the heart of Headingley.

**Key Features:**

**Spacious Lounge:** A large living area with elegant wood flooring, perfect for relaxation and entertaining.

**Separate Kitchen:** A fully equipped kitchen, designed for both functionality and style.

**Two Double Bedrooms:** Each bedroom is fully furnished, featuring a wardrobe, desk, chair, and chest of drawers, providing ample storage and workspace.

**A Tiled Bathroom:** Modern and stylish, ensuring comfort and convenience.

**Modern Electric Heating:** Efficient and easy to control, ensuring a warm and cozy environment year-round.

This property is ideal for those seeking a comfortable and stylish living space in a prime location.

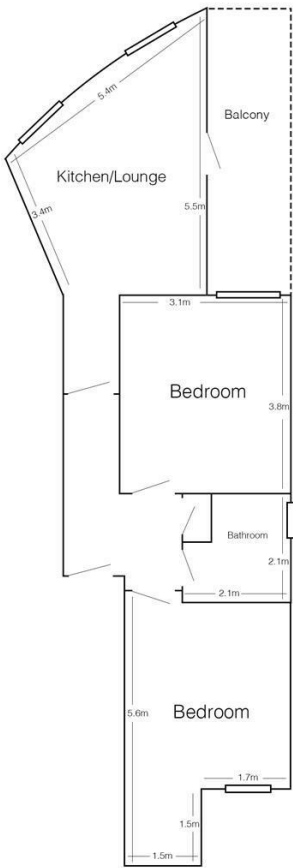

8 New Moon  
(drawing not to scale)

Call us on

01132782201

phil@sjm-properties.com

sjm-properties.com

Council Tax Band

C

Energy Efficiency Rating		
	Current	Potential
Very energy efficient - lower running costs		
(92 plus) A		
(81-91) B		
(69-80) C	69	70
(55-68) D		
(39-54) E		
(21-38) F		
(1-20) G		
Not energy efficient - higher running costs		
England & Wales		EU Directive 2002/91/EC

Agents Note: Whilst every care has been taken to prepare these particulars, they are for guidance purposes only. All measurements are approximate and are for general guidance purposes only and whilst every care has been taken to ensure their accuracy, they should not be relied upon and potential buyers are advised to recheck the measurements.

**SJM** <sup>©</sup>  
**PROPERTIES**