

## 33 TOFT AVENUE

GRAYS, RM17 5SP

£375,000  
FREEHOLD

Thomas Marsh is pleased to present this inviting three-bedroom terraced home, perfect for families seeking comfort and convenience.

### Key Features:

- \* Spacious Lounge/Diner: A bright and airy space ideal for family gatherings and entertaining guests.
- \* Ground Floor Cloakroom: A practical addition for busy households.

**tm**  
thomas marsh



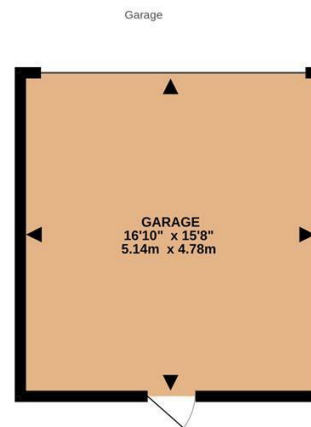
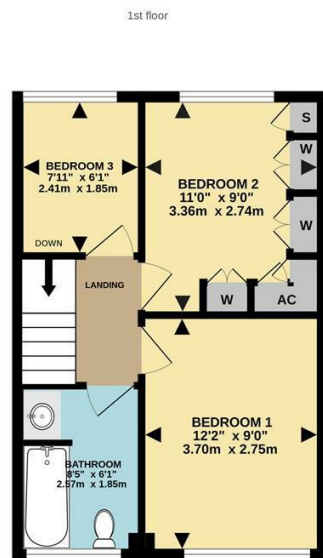

epcsinessex

Whilst every attempt has been made to ensure the accuracy of the floorplan contained here, measurements of doors, windows, rooms and any other items are approximate and no responsibility is taken for any error, omission or mis-statement. This plan is for illustrative purposes only and should be used as such by any prospective purchaser. The services, systems and appliances shown have not been tested and no guarantee as to their operability or efficiency can be given.  
Made with Metropix ©2025

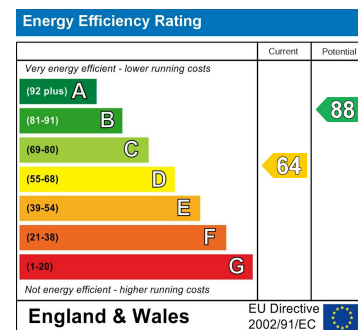
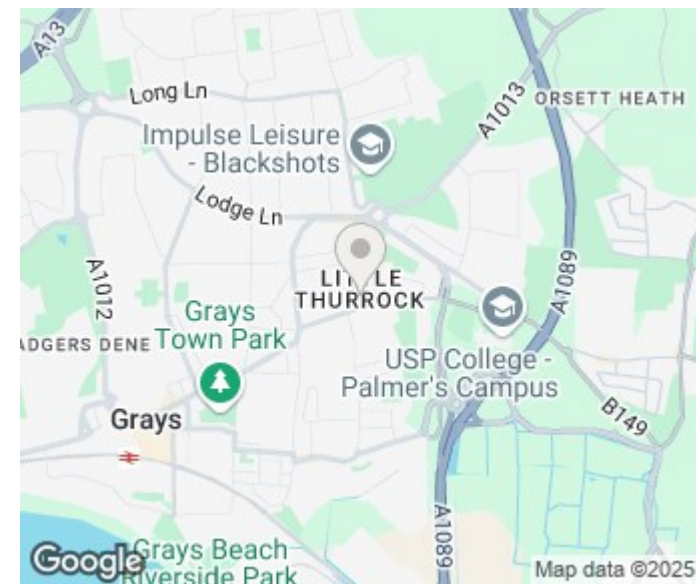

Agents Note: Whilst every care has been taken to prepare these particulars, they are for guidance purposes only. All measurements are approximate and are for general guidance purposes only and whilst every care has been taken to ensure their accuracy, they should not be relied upon and potential buyers/tenants are advised to recheck the measurements

Grays Sales  
47 Orsett Road  
Grays  
Essex  
RM17 5HJ

01375 370779  
sales@thomas-marsh.com  
www.thomas-marsh.com

