



16 BREDLE WAY

SOUTH OCKENDON, RM15 4ES

£550,000
LEASEHOLD

Situated in a prime location within the development, this stunning four bedroom family house is finished to the highest of standards, benefiting from a large and beautifully presented landscaped garden, along with off-street parking. The property comprises a stylish and modern kitchen/diner, living room with views over the garden, down stairs cloakroom, a modern first floor family bathroom, four bedrooms and a stylish en-suite shower room off the master bedroom. The property boasts a large garden with artificial grass, and benefits from side access.

Aveley is well connected for local amenities, shops, transport links and schools. Within a short drive is Lakeside shopping centre, the A13, M25, and Dartford Crossing.

tm
thomas marsh

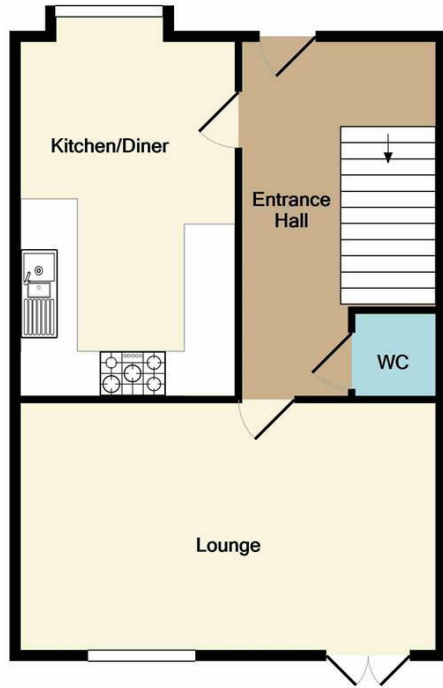

Ground Floor

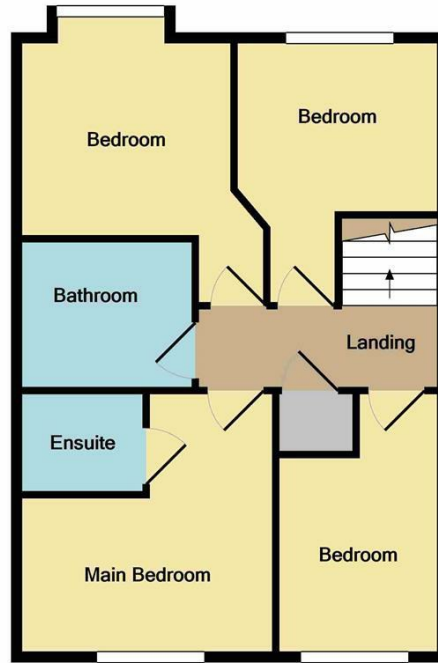

1st Floor

Whilst every attempt has been made to ensure the accuracy of the floor plan contained here, measurements of doors, windows, rooms and any other items are approximate and no responsibility is taken for any error, omission, or mis-statement. This plan is for illustrative purposes only and should be used as such by any prospective purchaser. The services, systems and appliances shown have not been tested and no guarantee as to their operability or efficiency can be given
 Made with Metropix ©2022



Energy Efficiency Rating		
	Current	Potential
Very energy efficient - lower running costs		
(92 plus) A		94
(81-91) B	84	
(69-80) C		
(55-68) D		
(39-54) E		
(21-38) F		
(1-20) G		
Not energy efficient - higher running costs		
England & Wales	EU Directive 2002/91/EC	

Agents Note: Whilst every care has been taken to prepare these particulars, they are for guidance purposes only. All measurements are approximate and are for general guidance purposes only and whilst every care has been taken to ensure their accuracy, they should not be relied upon and potential buyers/tenants are advised to recheck the measurements

Grays Sales
 47 Orsett Road
 Grays
 Essex
 RM17 5HJ

01375 370779
 sales@thomas-marsh.com
 www.thomas-marsh.com

