

# HUNTERS®

HERE TO GET *you* THERE

**5 Stansfield Close, Bradford, West Yorkshire, BD10 0EN**

**Asking Price £279,950**

Property Images



# HUNTERS®

HERE TO GET *you* THERE

## Property Images



# HUNTERS®

HERE TO GET *you* THERE

## Floorplan

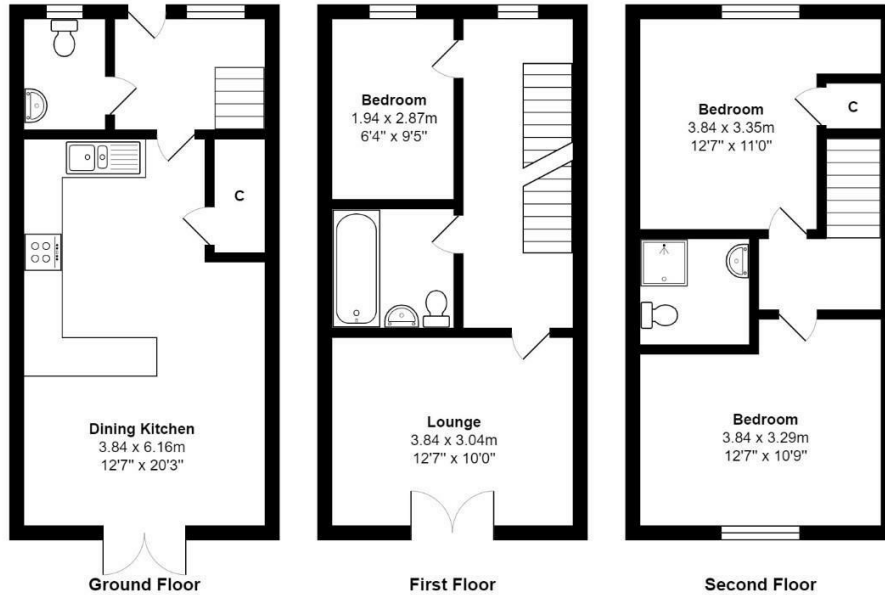

Total Area: 93.1 m<sup>2</sup> ... 1002 ft<sup>2</sup>

All measurements are approximate and for display purposes only

## EPC

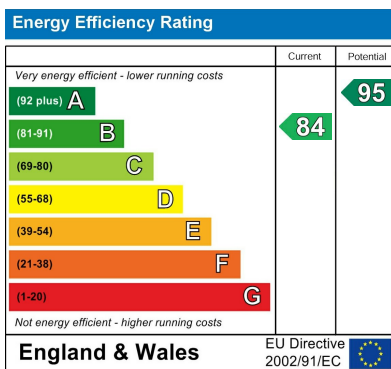

## Map

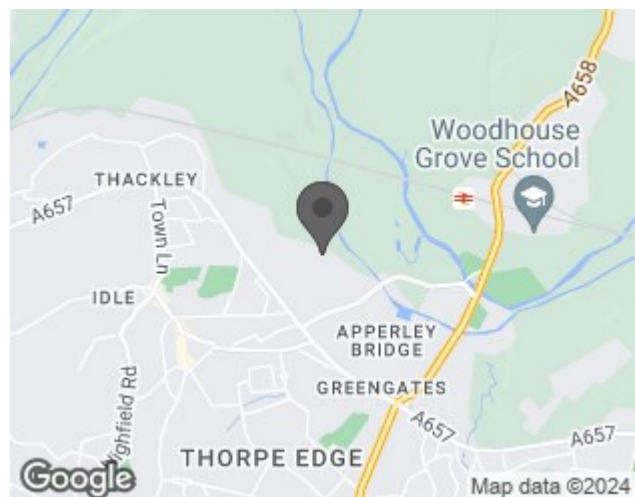

## Details

Type: House - Townhouse Beds: 3 Bathrooms: 3 Receptions: 2 Tenure: Freehold

## Summary

With open views to fields to the rear, a cul de sac position, and high quality fixtures throughout this luxurious modern townhouse situated within this sought after development is not to be missed. With a master suite, Juliet style balcony and enclosed rear garden the property is sure to make the perfect family home.

Accommodation briefly consists of an entrance hallway, guest wc and the open plan living kitchen with breakfast bar and French doors leading out to the rear garden. To the first floor can be found the lounge with lovely valley views to the rear, the main house bathroom and bedroom three. The master bedroom with ensuite is on the second floor along with bedroom two.

Externally there is off-street parking to the front for two cars and an electric car charging point. The rear garden is lawned with fenced boundaries.

The property is within easy reach of several picturesque woodland and canal side walks, a wide range of amenities, a train station and several highly regarded primary and secondary schools. The property also benefits from the remainder of the builders guarantee.

## Features

• MODERN TOWNHOUSE • STUNNING VALLEY VIEWS • SOUGHT AFTER DEVELOPMENT • LOUNGE WITH JULIET STYLE BALCONY • OPEN PLAN LIVING KITCHEN • REMAINDER OF BUILDERS GUARANTEE • GUEST WC • TWO PARKING SPACES WITH CHARGING POINT • ENSUITE TO MASTER • HUNTERS 360 TOUR EPC RATING B