



FOR STARTERS



PCM
£775 PCM

MAIN COURSE

****One Bedroom Ground Floor Apartment within Walking Distance of Town Centre****

A well-proportioned ground floor apartment offering comfortable and practical living space. The property features a separate fitted kitchen, a good-sized lounge/diner, a double bedroom with built-in wardrobes, and a bathroom.

Conveniently located within easy walking distance of Stratford-upon-Avon town centre, this apartment is ideal for a single professional or couple looking to be close to local shops, restaurants, and transport links.

Sorry no smokers or pets.

Available from the 25th of August



LOCATION

Please see Tenancy Information under the Lettings heading on the toolbar on our website.

KEY INGREDIENTS



Tenure



Council Tax
Band - B



EPC
Band - D



TBC



Heating system
TBC



TBC

WHY NOT TAKE
A LOOK INSIDE?
GIVE US A CALL
01789 414222

Ground Floor

Approx. 48.9 sq. metres (526.5 sq. feet)

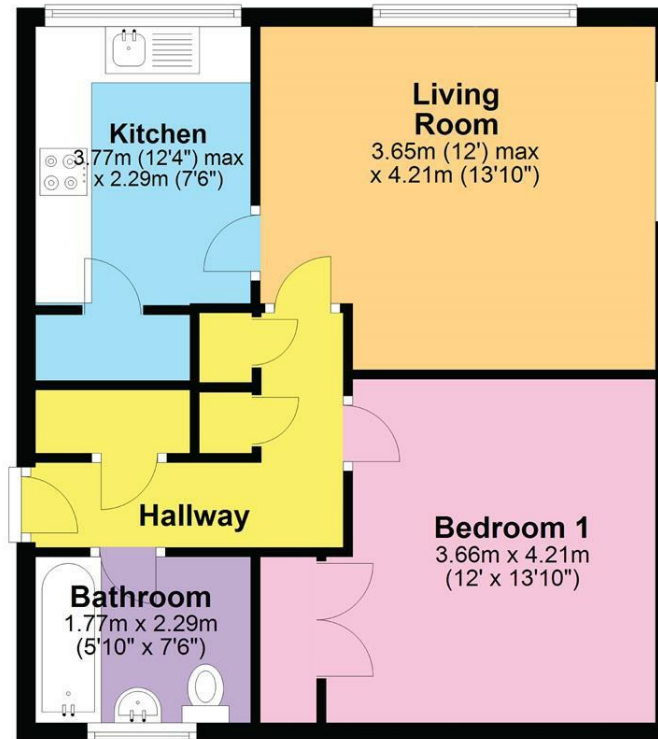

Total area: approx. 48.9 sq. metres (526.5 sq. feet)

DISCLAIMER - Floor plans shown are for general guidance only. Whilst every attempt has been made to ensure that the floorplan measurements are as accurate as possible, they are for illustrative purposes only.

**FOR MORE INFO AND
TO SEE OUR OTHER
LOVELY PROPERTIES
CHECK OUT OUR WEBSITE**

MOVEWITHEDWARDS.CO.UK

**HAVE YOU GOT
A PROPERTY
TO SELL?
WE'D LOVE TO
HAVE A CHAT
01789 414222**

**DID YOU KNOW WE ALSO
DO MORTGAGES.
FOR FREE ADVICE
SPEAK TO
ONE OF OUR
CONSULTANTS**

