



FOR STARTERS



PCM
£1,100 PCM

MAIN COURSE

A lovely two bedroom semi-detached house within easy walking distance of the town centre.

The downstairs comprises of a spacious living room with feature fireplace, leading to the dining room which has a patio door leading to the back garden. There is a modern kitchen which comes with an all-in-one cooker, and freestanding fridge/freezer. A washing machine is also provided which is situated in the outbuilding.

Upstairs is a spacious master bedroom and a good sized double bedroom. In between the two bedrooms is a modern bathroom with a large bath and separate shower cubicle.

The property also comes with a good sized, easy to maintain rear garden.

Sorry no pets.
Available the 20th of June.



LOCATION

KEY INGREDIENTS



Tenure



Council Tax
Band - B



EPC
Band - D



TBC



Heating system
TBC



TBC

WHY NOT TAKE
A LOOK INSIDE?
GIVE US A CALL
01789 414222



Ground Floor

Approx. 33.4 sq. metres (359.4 sq. feet)

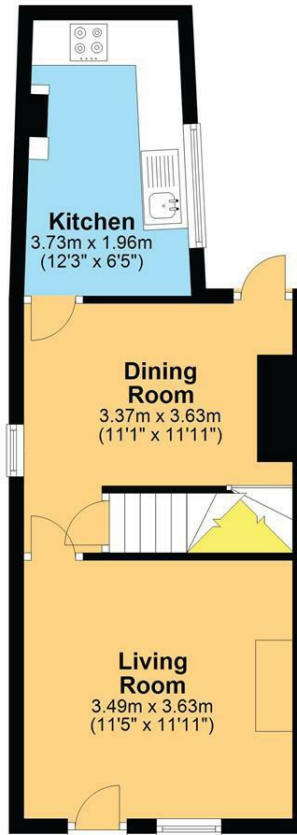

First Floor

Approx. 33.4 sq. metres (359.2 sq. feet)



Basement

Approx. 9.1 sq. metres (97.6 sq. feet)

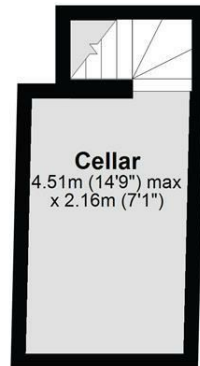

Total area: approx. 75.8 sq. metres (816.2 sq. feet)

DISCLAIMER - Floor plans shown are for general guidance only. Whilst every attempt has been made to ensure that the floorplan measurements are as accurate as possible, they are for illustrative purposes only.

FOR MORE INFO AND
TO SEE OUR OTHER
LOVELY PROPERTIES
CHECK OUT OUR WEBSITE

MOVEWITHEDWARDS.CO.UK

HAVE YOU GOT
A PROPERTY
TO SELL?
WE'D LOVE TO
HAVE A CHAT
01789 414222

DID YOU KNOW WE ALSO
DO MORTGAGES.
FOR FREE ADVICE
SPEAK TO
ONE OF OUR
CONSULTANTS

