



Holland Park Avenue

Holland Park, London, W11 4XB

£992 Per Week

A beautifully bright and spacious three double bedroom, three bathroom modern apartment located on the 7th floor of a modern residential building, moments walk from both Shepherds Bush and Holland Park underground stations. The property comprises of:- Entrance hallway with storage, bright open plan living room/kitchen with wooden flooring and access to private balcony, two double bedroom suites each with en-suite bathrooms, third double bedroom/dining room and third family bathroom. The property also benefits from having lift, daytime concierge, double glazing and wooden flooring, this property is perfect for a family or NO MORE THAN TWO SHARERS. Offered unfurnished and available now.

- Three Double Bedrooms
- Three Bathrooms
- Wood Flooring
- Seventh Floor
- Daytime Porter
- Walk to Westfield

Viewing

Please contact our Messila Residential Office on 020 7586 6699 if you wish to arrange a viewing appointment for this property or require further information.

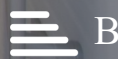

Floor Plan

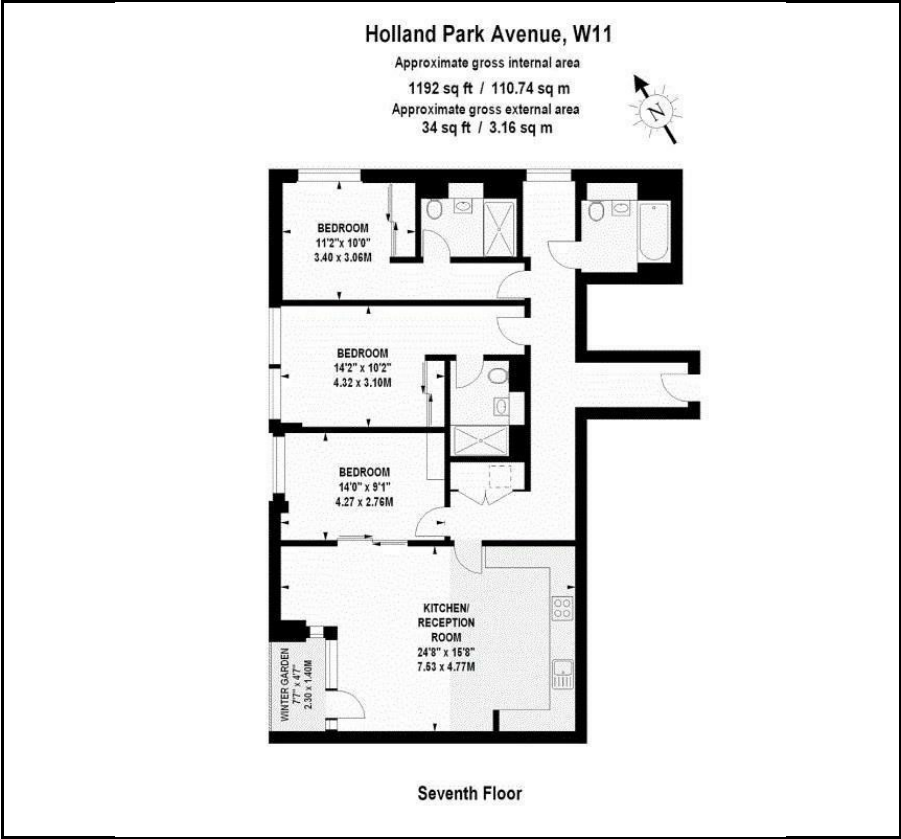

Area Map

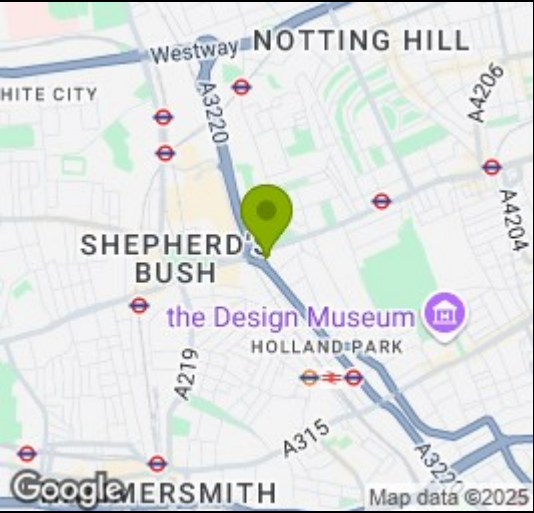

Energy Efficiency Graph

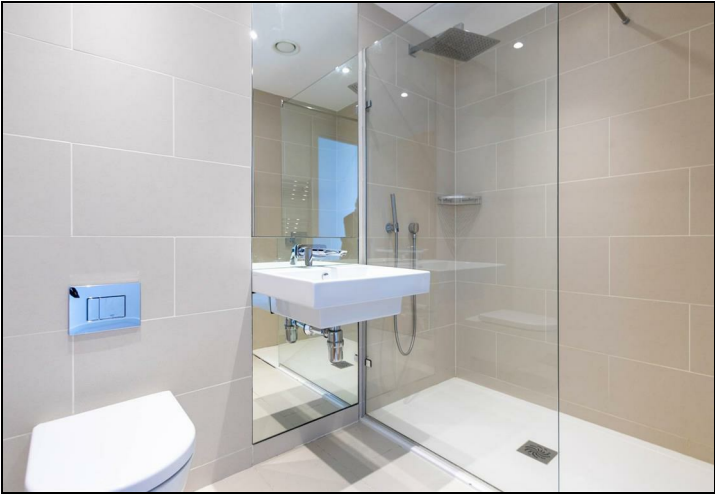
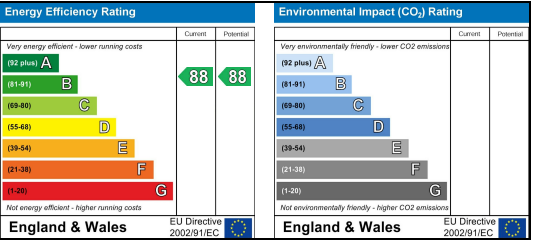

These particulars, whilst believed to be accurate are set out as a general outline only for guidance and do not constitute any part of an offer or contract. Intending purchasers should not rely on them as statements of representation of fact, but must satisfy themselves by inspection or otherwise as to their accuracy. No person in this firms employment has the authority to make or give any representation or warranty in respect of the property.