



Fursecroft

George Street, Marylebone, W1H 5LG

£425 Per Week

This is a spacious studio apartment situated on the LOWER GROUND floor of this secured purpose built block, close to all the West End facilities. Well presented with wooden flooring and neutral furnishing. Open plan living and with fitted kitchen and large shower/WC. The flat has benefit of communal heating and hot water included in rent. The property is located within easy walking distance to Marble Arch Station (Central Line) and the world renowned Hyde Park and Oxford Street are within easy walking distance. The property is offered furnished and is available from 11th September for long let.

- Portered building
- Heating and HW included
- Moments to shops
- Moments to tube station
- Moments to Hyde Park
- Marble Arch & Oxford street
- Marylebone and Connaught villages are near by

Viewing

Please contact our Messila Residential Office on 020 7586 6699 if you wish to arrange a viewing appointment for this property or require further information.

Floor Plan

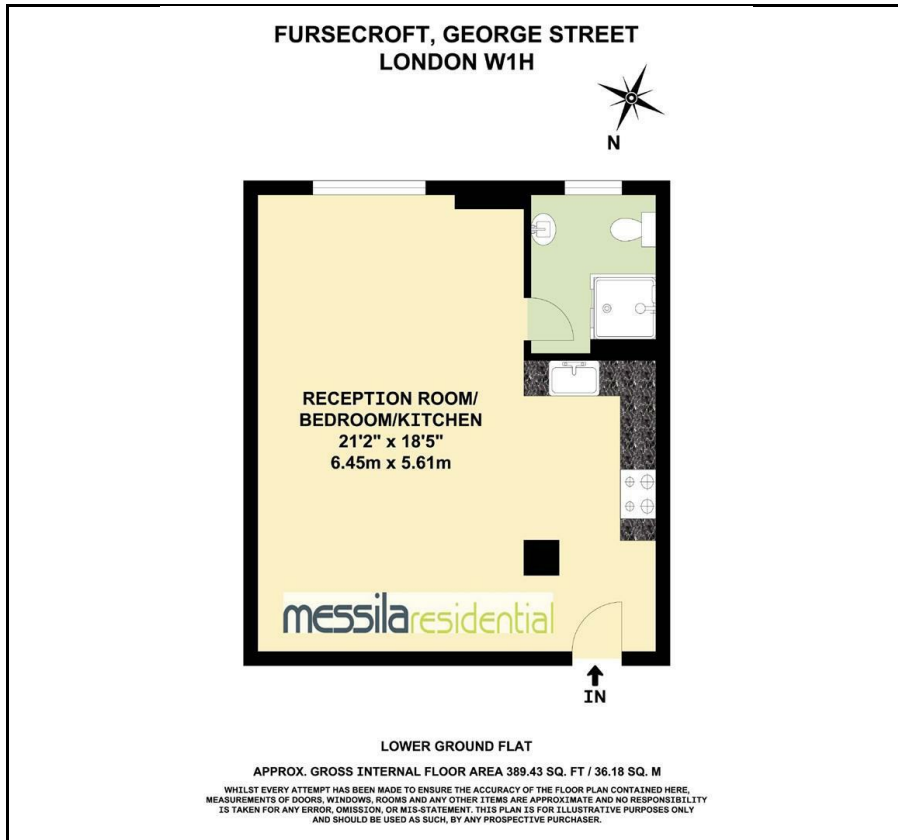

Area Map



Energy Efficiency Graph

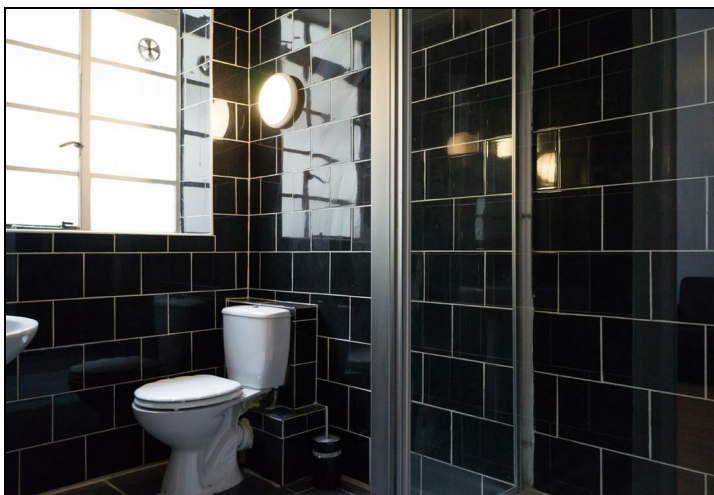
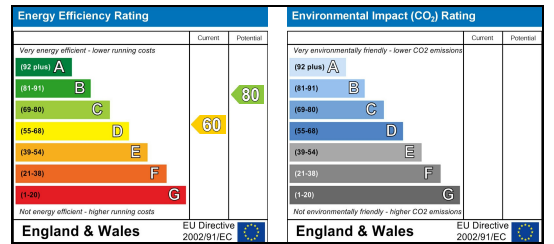

These particulars, whilst believed to be accurate are set out as a general outline only for guidance and do not constitute any part of an offer or contract. Intending purchasers should not rely on them as statements of representation of fact, but must satisfy themselves by inspection or otherwise as to their accuracy. No person in this firm's employment has the authority to make or give any representation or warranty in respect of the property.

Messila Residential

137 Park Road, London, NW8 7HT

T: 020 7586 6699 E: regentspark@messilaresidential.com W: messilaresidential.com