



Lords View

St John's Wood Road, St John's Wood, NW8 7HQ

£1,000 Per Week

This is a large three double bedroom apartment with balcony situated on the fourth floor (with lift) located opposite 'Lords' cricket ground. This property had a full refurbishment and includes all of the brand new furniture and new fixtures and fittings. This fine flat comprises of:- Entrance hallway with plenty of storage, spacious living room with private balcony with direct views of Lords cricket ground, separate brand new kitchen, three double bedrooms (master with en-suite bathroom), second bathroom.

The property also benefits from having concierge, lifts access, private balcony. The property is within 5 minutes walk to 'London Business School', Regents' Park and St John's Wood Station.

The property is offered furnished and available now for long letting only- Ideal for 3 LBS gentlemen/ladies.

- Three Double Bedrooms
- Two Bathrooms
- Large bright Reception
- Balcony facing Lords CG.
- Day porter
- Fourth Floor
- Brand new refurbishment

Viewing

Please contact our Messila Residential Office on 020 7586 6699 if you wish to arrange a viewing appointment for this property or require further information.



Floor Plan

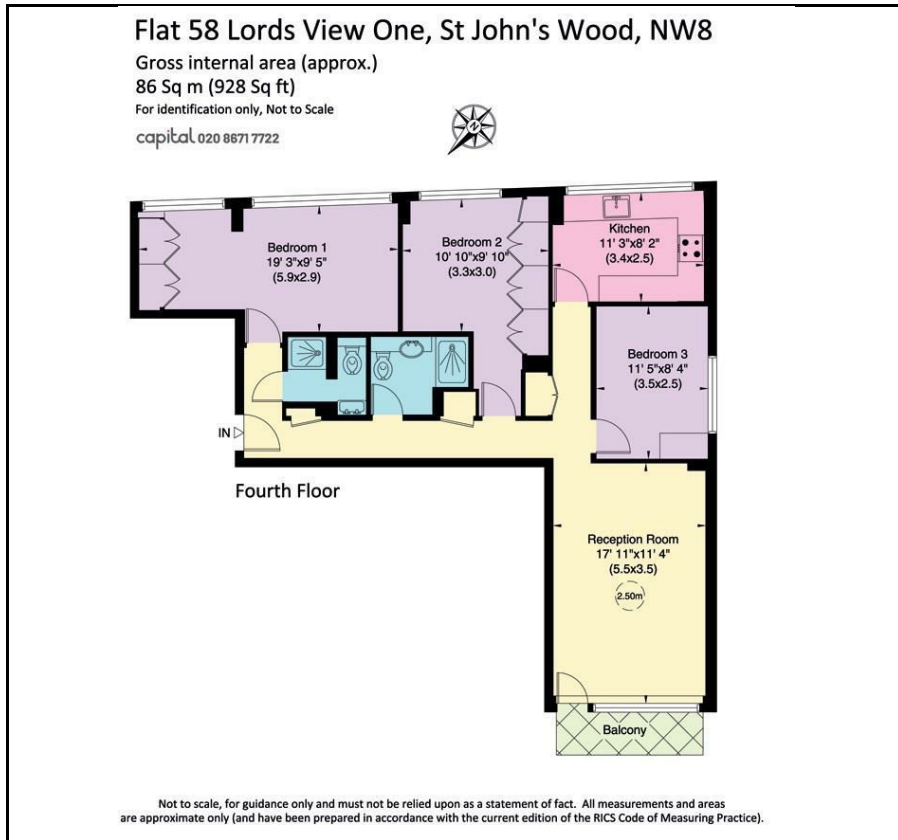

Area Map



Energy Efficiency Graph

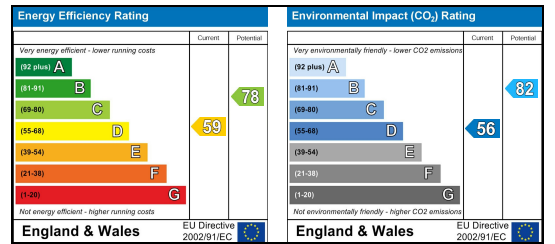

These particulars, whilst believed to be accurate are set out as a general outline only for guidance and do not constitute any part of an offer or contract. Intending purchasers should not rely on them as statements of representation of fact, but must satisfy themselves by inspection or otherwise as to their accuracy. No person in this firm's employment has the authority to make or give any representation or warranty in respect of the property.

Messila Residential

137 Park Road, London, NW8 7HT

T: 020 7586 6699 E: regentspark@messilaresidential.com W: messilaresidential.com