



Warwick House

Windsor Way, London, W14 0UQ

£807 Per Week

This is well presented bright and spacious SECOND FLOOR two double bedroom apartment with underground parking that has had a refurbishment throughout. This fine property is set in a secure gated development with 24 hour security and is within walking distance of Kensington High Street. The property comprises of; large reception / dining room, with wooden flooring, brand newly fitted kitchen, large master bedroom with en-suite bathroom, second double sized bedroom and family bathroom/wc. This property is on the second floor of this extremely well maintained development which is centrally located between Hammersmith and Kensington stations. Offered furnished and available now for long let.

- Underground Parking
- Double Bedrooms
- 24 Hours Concierge
- En-suite Bathroom

Viewing

Please contact our Messila Residential Office on 020 7586 6699 if you wish to arrange a viewing appointment for this property or require further information.



Floor Plan

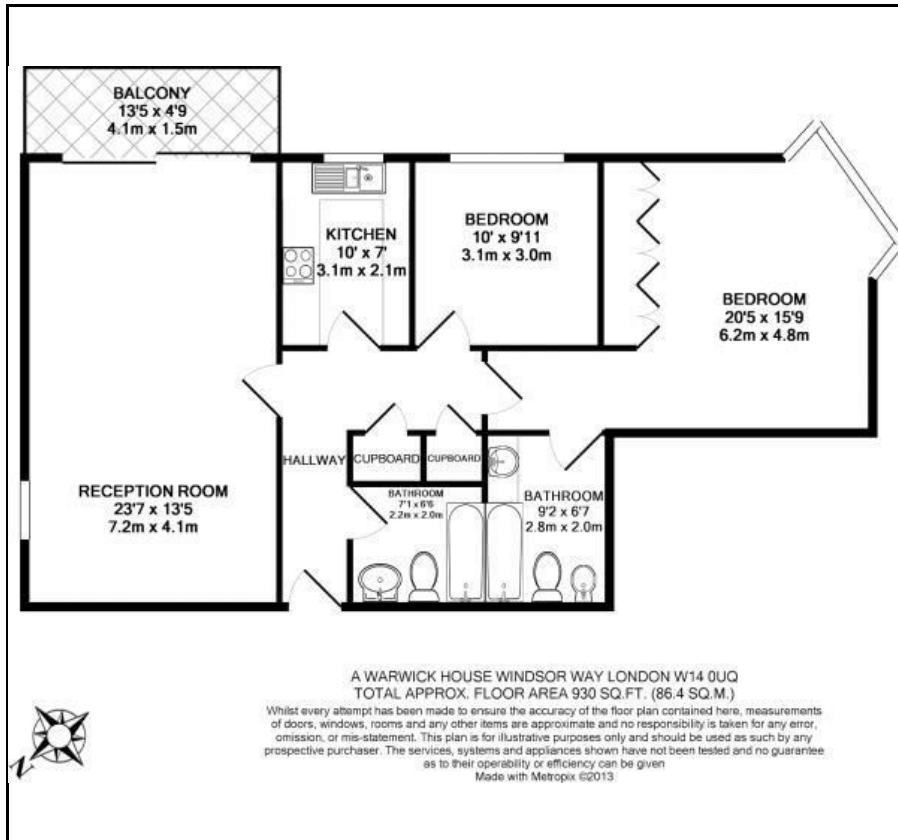

Area Map

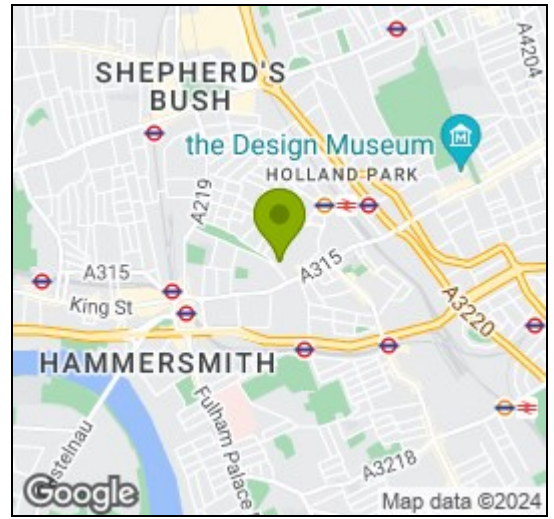

Energy Efficiency Graph

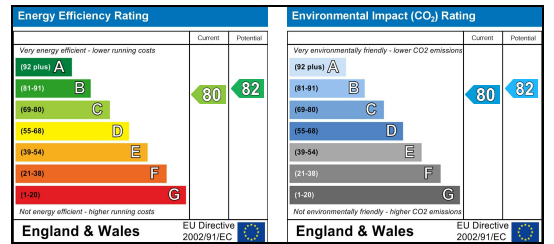

These particulars, whilst believed to be accurate are set out as a general outline only for guidance and do not constitute any part of an offer or contract. Intending purchasers should not rely on them as statements of representation of fact, but must satisfy themselves by inspection or otherwise as to their accuracy. No person in this firm's employment has the authority to make or give any representation or warranty in respect of the property.

Messila Residential

137 Park Road, London, NW8 7HT

T: 020 7586 6699 E: regentspark@messilaresidential.com W: messilaresidential.com