



## Mazenod Avenue

, West Hampstead, NW6 4LR

£475 Per Week

This bright and modern two bedroom (1 x double, 1 x single) FIRST floor apartment within this great residential locale. This fine red brick building was modernised throughout with 5 separate flats.

The property comprises of:- Entrance hallway with storage/utility cupboard, bright open plan reception room with bay window and fitted modern kitchen, good sized double bedroom with fitted wardrobe and large window, one single bedroom with window overlooking Mazenod ave., shower /WC and a utility cupboard. The property also benefits from having wooden flooring, double glazing and high ceiling, with easy walking distance to both West Hampstead/West End Lane and Kilburn high street, affording great transport links, with ample shopping facility.

The flat is offered furnished and is available NOW for long let.

AN IDEAL FLAT FOR A COUPLE OR 2 SHARERS.

- Two Bedrooms
- Modern furnishings
- FIRST Floor
- Wooden Flooring
- Close to the Station

### Viewing

Please contact our Messila Residential Office on 020 7586 6699 if you wish to arrange a viewing appointment for this property or require further information.

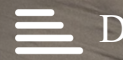
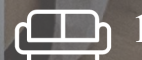

## Floor Plan

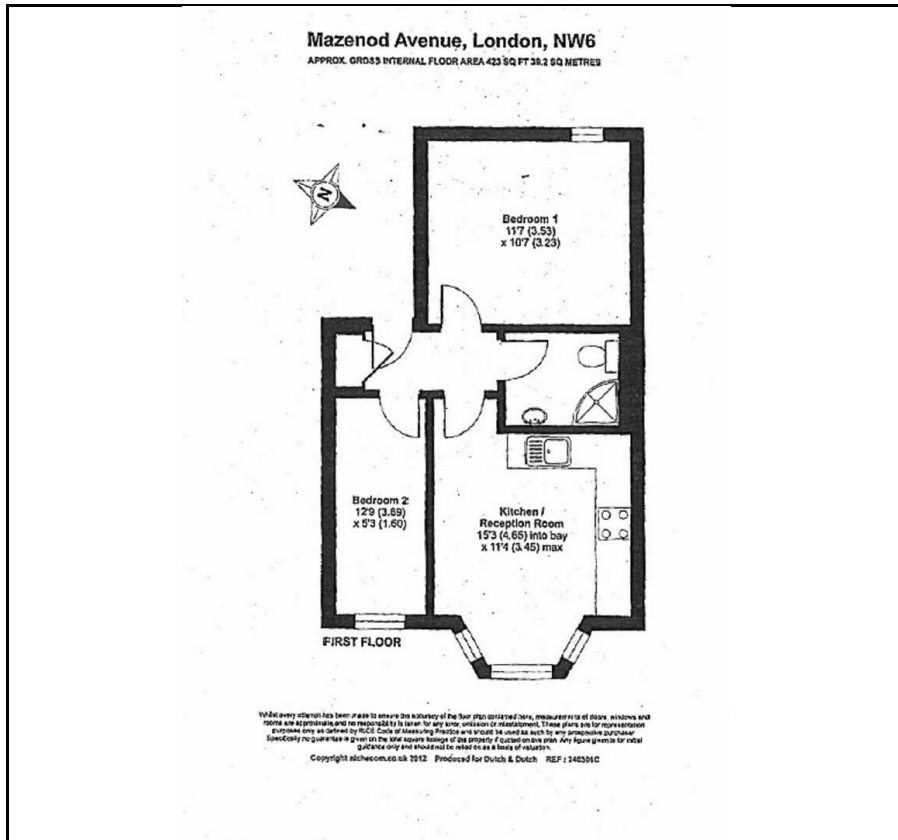

## Area Map



## Energy Efficiency Graph

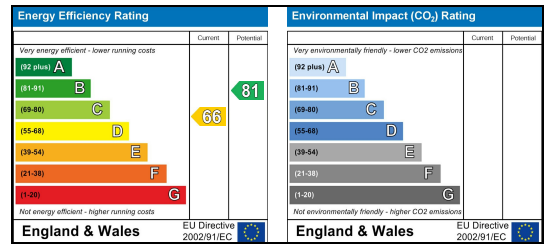

These particulars, whilst believed to be accurate are set out as a general outline only for guidance and do not constitute any part of an offer or contract. Intending purchasers should not rely on them as statements of representation of fact, but must satisfy themselves by inspection or otherwise as to their accuracy. No person in this firm's employment has the authority to make or give any representation or warranty in respect of the property.

### Messila Residential

137 Park Road, London, NW8 7HT

T: 020 7586 6699 E: regentspark@messilaresidential.com W: messilaresidential.com