



## Lords View

St John's Wood Road, St John's Wood, NW8 7HQ

£950 Per Week

A newly refurbished spacious three double bedroom apartment on the second floor in this sought after and well located portered residence in St John's Wood.

The building has recently undergone a huge refurbishment throughout with brand new lobby, common parts, with secure entry and with lifts, the property also comes with separate lockable garage, and is located opposite the world renowned Lord's Cricket Ground, St John's wood High street, Regents' Park and Baker Street all just within easy walking distance away.

This fine flat benefits from having three bedrooms (master with en-suite), family bathroom/WC, separate fitted kitchen, large reception/dining room, porter and two private balconies (one facing Lords), as well as brand new wooden flooring throughout. The property is can be let either furnished or unfurnished and is available NOW for one year or longer. An ideal home for family rental.

- Three Double Bedrooms
- Two Bathrooms
- Second Floor
- Brand new refurbishment
- Wood flooring
- opposite Lords CG.
- Close to Regent's park
- Garage

### Viewing

Please contact our Messila Residential Office on 020 7586 6699 if you wish to arrange a viewing appointment for this property or require further information.



## Floor Plan

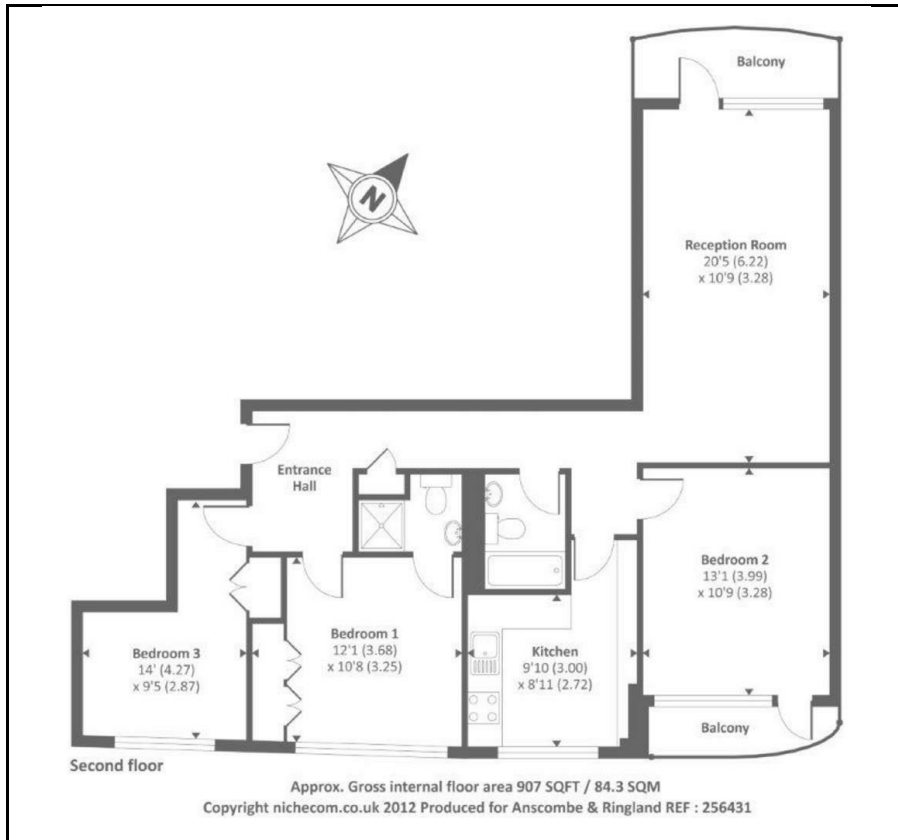

## Area Map

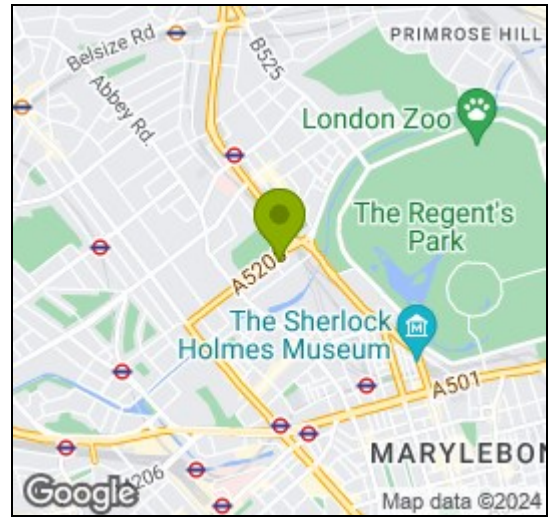

## Energy Efficiency Graph

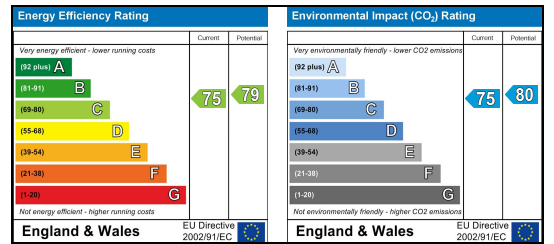

These particulars, whilst believed to be accurate are set out as a general outline only for guidance and do not constitute any part of an offer or contract. Intending purchasers should not rely on them as statements of representation of fact, but must satisfy themselves by inspection or otherwise as to their accuracy. No person in this firm's employment has the authority to make or give any representation or warranty in respect of the property.

### Messila Residential

137 Park Road, London, NW8 7HT

T: 020 7586 6699 E: regentspark@messilaresidential.com W: messilaresidential.com