



## Marina Point

Lensbury Avenue, Fulham, SW6 2GX

£807 Per Week

A spacious two double bedroom apartment situated on the second floor (with lift) within the prestigious 'Imperial Wharf' development. This property comprises of, entrance hallway, spacious reception room, with semi-open plan kitchen, two double bedrooms, master with en-suite and second family bathroom. The flat also benefits from having Secure entry, wood flooring, 24 hour concierge, balcony.

The development is located within a few mins walk of Imperial Wharf Station along with other excellent transport links. The property is available NOW and is offered furnished for long let (Break option).

- Two Double Bedrooms
- Two Bathrooms
- Second Floor
- 24 Hour Concierge
- Wooden Flooring

### Viewing

Please contact our Messila Residential Office on 020 7586 6699 if you wish to arrange a viewing appointment for this property or require further information.

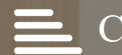

## Floor Plan

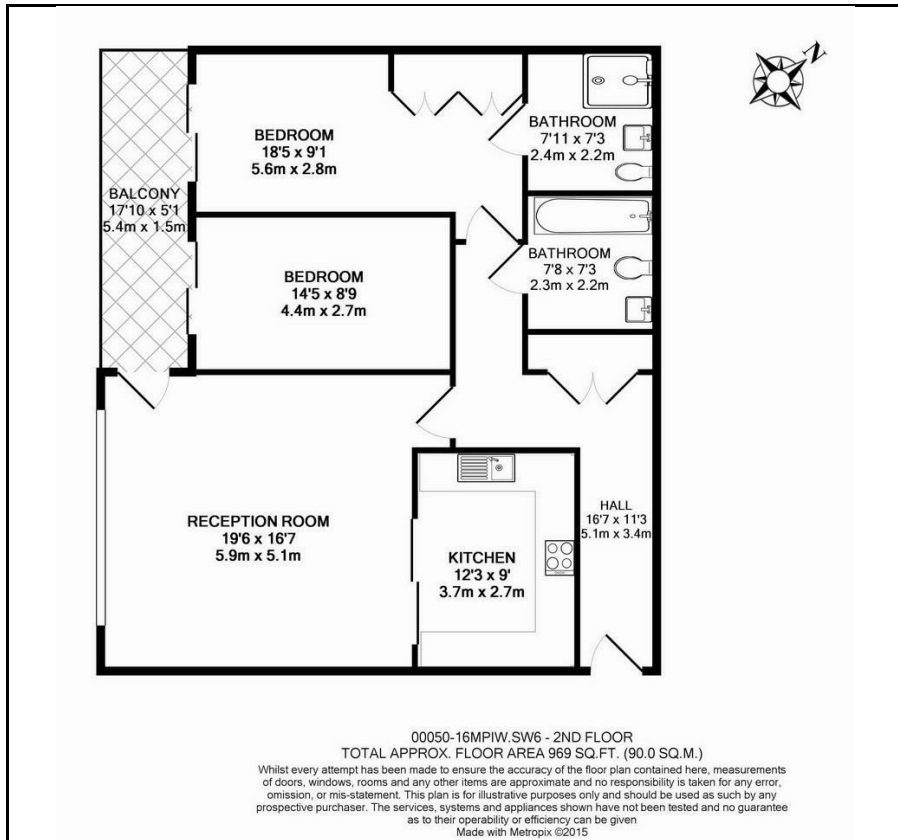

## Area Map



## Energy Efficiency Graph

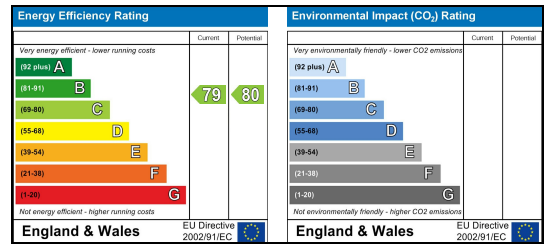

These particulars, whilst believed to be accurate are set out as a general outline only for guidance and do not constitute any part of an offer or contract. Intending purchasers should not rely on them as statements of representation of fact, but must satisfy themselves by inspection or otherwise as to their accuracy. No person in this firm's employment has the authority to make or give any representation or warranty in respect of the property.

### Messila Residential

137 Park Road, London, NW8 7HT

T: 020 7586 6699 E regentspark@messilaresidential.com W: messilaresidential.com