



Orbis Wharf

Battersea, SW11 3GX

PROPERTY SUMMARY

A stylish two-bedroom apartment in a secure Battersea riverside development. Recently refurbished with a new kitchen, ceramic wood-effect flooring, and upgraded bathrooms for modern living. It features two private balconies, one accessed from the reception room and another from the master bedroom.





BRIDGES WHARF, SW11

Approx. Gross Internal Floor Area
828 Sq. ft/76.92 Sq. m

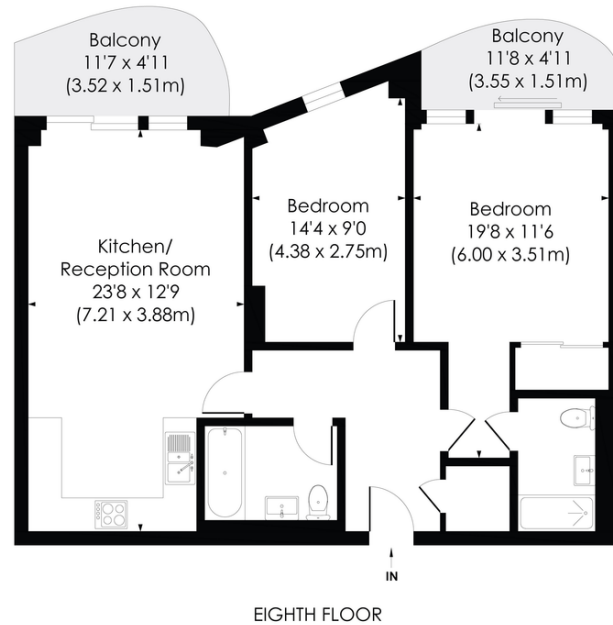

pixangle
PROPERTY MARKETING

This floor plan has been prepared for the purpose of illustration only in accordance with the latest RICS code of measuring practice and is not to scale. All measurements and areas are approximate and whilst every effort has been made to ensure the accuracy of the plan contained here, no responsibility is taken for any error, omission or misstatement.

© Pixangle Property Marketing Ltd. info@pixangle.com Tel: 0208 870 2118

LOCAL AUTHORITY

Wandsworth Borough Council

TENURE

Leasehold

COUNCIL TAX BAND

Band E

VIEWINGS

By prior appointment only

Score	Energy rating	Current	Potential
92+	A		
81-91	B	82 B	83 B
69-80	C		
55-68	D		
39-54	E		
21-38	F		
1-20	G		

Agents Note: Whilst every care has been taken to prepare these particulars, they are for guidance purposes only. All measurements are approximate and are for general guidance purposes only and whilst every care has been taken to ensure their accuracy, they should not be relied upon and potential buyers/tenants are advised to recheck the measurements



4 Vicentia Court
Bridges Wharf
London
SW11 3GY

02073522455
info@hgproperty.co.uk
www.hgproperty.co.uk