

Orbis Wharf
London, SW11 3GX

PROPERTY SUMMARY

A spectacular two bedroom, two bathroom apartment with a fantastic terrace and river views. The apartment is situated on the tenth floor with all the principal rooms benefitting from excellent views. With a westerly aspect the apartment is bright and ideal for taking in the afternoon and evening sun with the added bonus of a large south-westerly facing terrace, ideal for entertaining.

2 

2 

1 





**Orbis Wharf,
Bridges Court Road, SW11**

Approximate Gross Internal Area

88.2 sq.m / 949 sq.ft

(CH = Ceiling Heights)

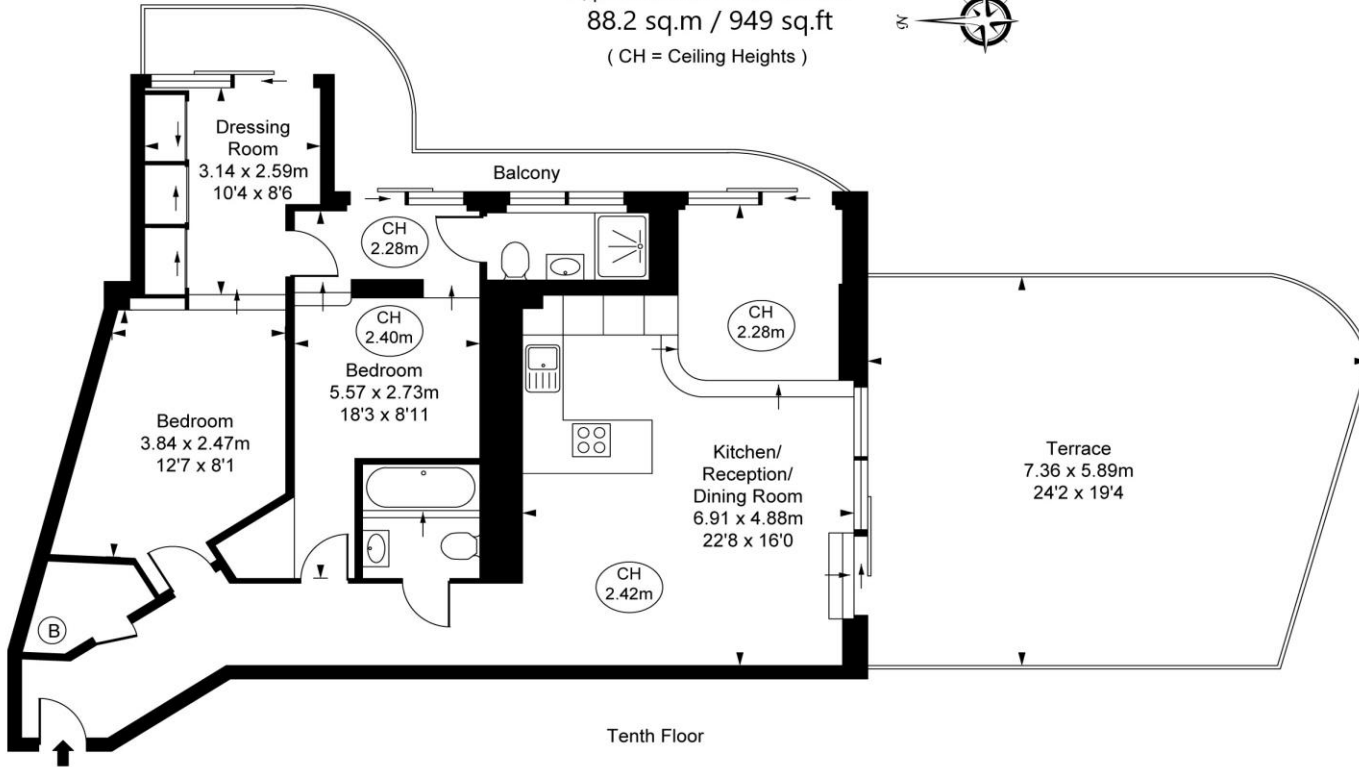

Tenth Floor

This plan is not to scale. It is for guidance and not for valuation purposes.
All measurements and areas are approximate only, and have been prepared in accordance with the current edition of the RICS Code of Measuring Practice.
© Fulham Performance

LOCAL AUTHORITY

Wandsworth Borough Council

TENURE

Leasehold

COUNCIL TAX BAND

Band F

VIEWINGS

By prior appointment only

Score	Energy rating	Current	Potential
92+	A		
81-91	B	82 B	82 B
69-80	C		
55-68	D		
39-54	E		
21-38	F		
1-20	G		

Agents Note: Whilst every care has been taken to prepare these particulars, they are for guidance purposes only. All measurements are approximate and are for general guidance purposes only and whilst every care has been taken to ensure their accuracy, they should not be relied upon and potential buyers/tenants are advised to recheck the measurements



4 Vicentia Court
Bridges Wharf
London
SW11 3GY

02073522455
info@hgproperty.co.uk
www.hgproperty.co.uk