

H&G

Ensign
HOUSE



Ensign HOUSE

A smart and well presented two bedroom apartment in the award winning Battersea Reach riverside development.

This welcoming fifth floor apartment offers just under 783 sq ft of accommodation comprising two double bedrooms, two bathrooms (one en suite), open plan kitchen/reception room and balcony.

The reception area is well proportioned with space for both living and dining areas with the fully fitted kitchen offering top of the range appliances and offers a useful breakfast bar.

The two bedrooms are spacious with the master benefiting from built in wardrobes and en suite shower room. The apartment has underfloor heating plus a private balcony.

To Let (part furnished)

Parking for one car included.





Battersea REACH

Battersea Reach offers a 24hr concierge service, residents gymnasium, coffee and cake shop, Tesco Express and a Young's riverside bar and restaurant.

Fashionable Old York Road with its boutiques, cafes, restaurants and shops is within close proximity.

Local transport links are provided by Wandsworth Town or Clapham Junction Station (National Rail) for connections into and out of central London with buses providing access across the river to Fulham and Chelsea.

A Thames Clipper river taxi service is now in operation, with the pier located just a few hundred yards away.

H&G

020 7352 2455

info@hgproperty.co.uk

www.hgproperty.co.uk

4 Vicentia Court, Bridges Wharf

BATTERSEA REACH, SW18

Approx. Gross Internal Floor Area

783 Sq. ft/72.7 Sq. m

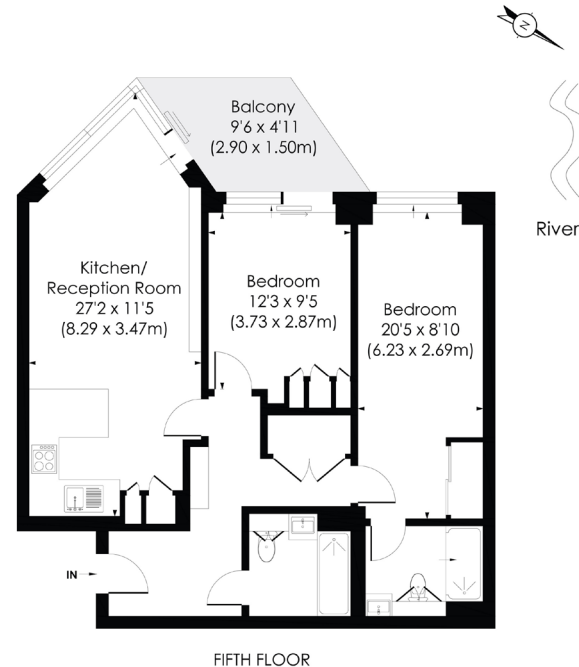

© Pixangle Property Marketing Ltd. info@pixangle.com Tel: 0208 870 2118

pixangle
PROPERTY MARKETING

This floor plan has been prepared for the purpose of illustration only in accordance with the latest RICS code of measuring practice and is not to scale. All measurements and areas are approximate and whilst every effort has been made to ensure the accuracy of the plan contained here, no responsibility is taken for any error, omission or misstatement.