



- CHAIN FREE!
- Spacious Three Storey House
- 3/4 Bedrooms
- 2 Bathrooms plus Downstairs WC

- Open Plan Kitchen/Diner
- First Floor Lounge
- Enclosed Rear Garden
- Allocated Parking & Garage

Whimbrel Chase, DN16 3WJ,
£189,950





Available to purchase with NO ONWARD CHAIN in the ever popular Lakeside area, this spacious end terrace house on Whimbrel Chase offers versatile living space over three floors. The accommodation briefly comprises of 2 bedrooms and a family bathroom to the second floor, lounge and master bedroom with fitted wardrobe and en-suite to the first floor, whilst downstairs boasts an entrance hall, WC, bedroom 4/study and an open plan kitchen/diner overlooking the rear garden. Outside the property has allocated parking, garage and low maintenance fully enclosed rear garden. The property sits in a great location within walking distance to a range of essential amenities including shops, schools and more. Viewing is highly recommended, call today to arrange! Freehold. Council tax band: C



Hallway

Having front entrance door, radiator, storage cupboard and stairs rising to the first floor.

WC

Having low level WC, radiator and wash hand basin.

Bedroom 4/Study

6' 1" x 9' 3" (1.85m x 2.82m)

Having uPVC double glazed window to the front aspect and vertical radiator.

Kitchen/Diner

12' 9" x 19' 9" (3.88m x 6.02m)

Having uPVC double glazed windows to the rear aspect, uPVC double glazed French doors opening onto the rear garden, radiator, ceiling spotlights, wall and base units with work surfaces over, inset sink and drainer unit, built in oven, hob and extractor, space/plumbing for white goods and breakfast bar.

First Floor Landing

Having stairs to the second floor.

Lounge

12' 9" x 12' 5" (3.88m x 3.78m)

Having two uPVC double glazed windows to the front aspect and two radiators.

Bedroom 1

12' 9" x 9' 8" (3.88m x 2.94m)

Having two uPVC double glazed windows to the rear aspect, radiator, built in wardrobes and door to en-suite.

En-suite

6' 3" x 6' 6" (1.90m x 1.98m)

Having shower cubicle, wash hand basin set in vanity unit, low level WC and heated towel rail.

Second Floor Landing

Bedroom 2

12' 9" x 10' 8" (3.88m x 3.25m)

Having uPVC double glazed window to the front aspect, radiator, built in cupboard and loft access.

Bedroom 3

12' 9" x 8' 1" (3.88m x 2.46m)

Having Velux window to the rear aspect and radiator.

Family Bathroom

5' 6" x 6' 5" (1.68m x 1.95m)

Having panelled bath with shower over, wash hand basin set in vanity unit, low level WC and heated towel rail.

Outside

Having a lawned garden to the front with pathway to the front door. The rear garden includes an Astroturf garden with a walled/fenced surround, door into garage and gate to parking area.





GROUND FLOOR

1ST FLOOR

2ND FLOOR

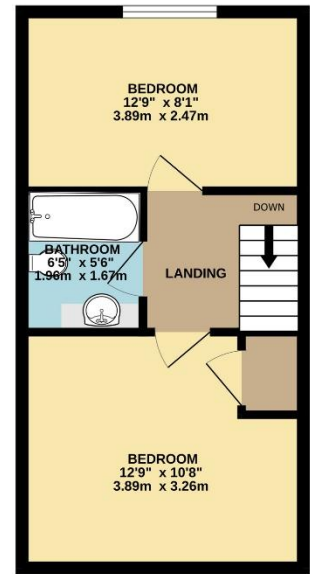
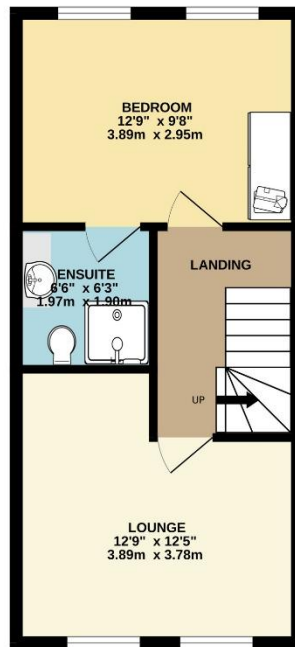
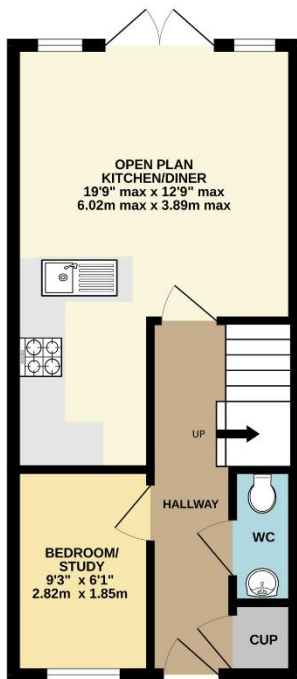

In order that we can assist you with your move as smoothly and efficiently as possible, our preferred Mortgage Adviser, can offer you advice on all your mortgage and protection needs, tailored to your individual circumstances. It will also be part of our qualifying process that you speak with our Mortgage Adviser when we ask the vendor to consider your offer. Your details may be passed onto third parties, please advise us if you do not wish this to happen.

Money Laundering regulations 2003: It is a mandatory requirement that all purchasers and sellers produce identification documentation before we can proceed with any sale. We thank you for your co-operation. Services: We regret that none of the services, equipment or appliances at the property have been tested by ourselves and therefore we cannot guarantee their working order or condition. Potential purchasers are strongly advised to carry out their own tests or enquiries before finalising their purchase. These particulars are issued as a general guide and do not form part of any contract nor do they at any stage represent factual information. Starkey & Brown trading as Starkey & Brown Ltd, 34 Silver Street, Lincoln, LN2 1EH. Company Registration Number 6081031

The information is provided and maintained by Starkey & Brown Estate Agents, Lincoln. Please contact selling agent or developer directly to obtain any information which may be available under the terms of the Energy Performance and Buildings (Certificates & Inspections) (England & Wales) Regulations 2007 and the Home Information Pack Regulations 2007.

Important Information:

All measurements are approximate. We have not tested any appliances or services within this property and cannot verify them to be in working order or within the vendors/s ownership. We have not verified the tenure of the property, type of construction or the condition thereof. Intending purchasers should make appropriate enquiries through their own solicitors and surveyor etc, prior to exchange of contract.

1 Oswald Road, Scunthorpe, DN15 7PU
T: 01724 856100
E: scunthorpe@starkeyandbrown.co.uk



www.starkeyandbrown.co.uk



**STARKEY
& BROWN**
YOUR LOCAL PROPERTY PEOPLE