



- Ideal First Time Buy/Investment
- Mid Terrace House
- 2 Bedrooms
- New Boiler 2021

- New uPVC Windows & Doors 2023
- Rear Garden
- Allocated Parking Space
- Chain Free!

Speedwell Crescent, Scunthorpe, DN15 8UR,
£115,000





Offered for sale with NO ONWARD CHAIN is this ideal first time buyer home/investment opportunity nearby to a fantastic range of amenities and convenient motorway links. The accommodation briefly comprises of 2 bedrooms and a bathroom to the first floor, whilst downstairs includes a kitchen and rear facing lounge with uPVC double glazed French doors onto a rear garden. Additional benefits include gas central heating (new boiler 2021), uPVC double glazed doors and windows (new 2023) and an allocated parking space. An internal inspection is highly recommended, call today to view! Freehold. Council tax band: A.



Entrance Hall

Having uPVC double glazed door to front aspect, radiator and stairs rising to first floor.

Kitchen

6' 5" x 6' 6" (1.95m x 1.98m)

Having uPVC double glazed window to front aspect, wall and base units with work surfaces over, inset sink and drainer unit and space/plumbing for appliances.

Lounge

12' 3" max x 14' 1" max (3.73m x 4.29m)

Having uPVC double glazed French doors to rear aspect, radiator and understairs storage cupboard.



First Floor Landing

Having linen cupboard and access to loft.

Bedroom 1

12' 5" max x 9' 5" max (3.78m x 2.87m)

Having uPVC double glazed window to front aspect x 2, radiator and storage cupboard.

Bedroom 2

6' 3" x 11' 1" (1.90m x 3.38m)

Having uPVC double glazed window to rear aspect and radiator.

Bathroom

5' 4" x 5' 7" (1.62m x 1.70m)

Having uPVC double glazed window to rear aspect, panelled bath with rainfall shower and additional handheld shower over, wash hand basin, low level WC and radiator.



Outside

The property includes an allocated parking space to the front. The rear garden is mainly laid to lawn with a fenced surround and paved patio area.



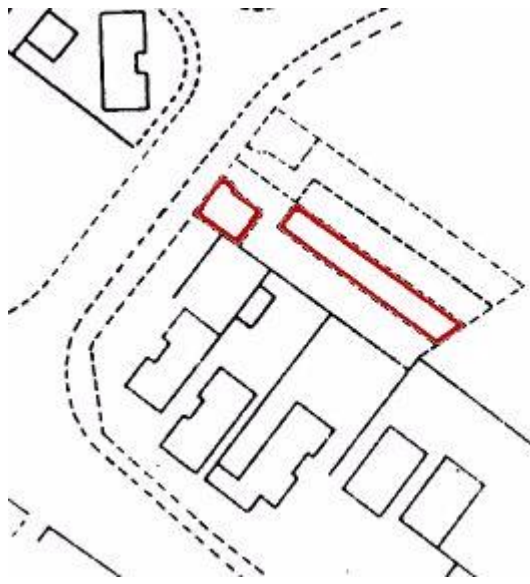

GROUND FLOOR

1ST FLOOR

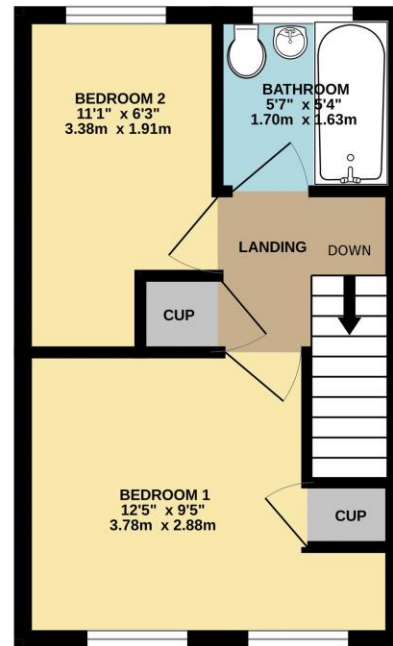
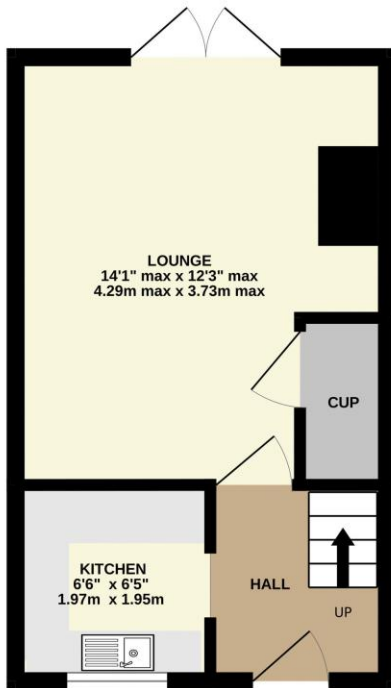

Whilst every attempt has been made to ensure the accuracy of the floorplan contained here, measurements of doors, windows, rooms and any other items are approximate and no responsibility is taken for any error, omission or mis-statement. This plan is for illustrative purposes only and should be used as such by any prospective purchaser. The services, systems and appliances shown have not been tested and no guarantee as to their operability or efficiency can be given.
Made with Metropix ©2024

In order that we can assist you with your move as smoothly and efficiently as possible, our preferred Mortgage Adviser, can offer you advice on all your mortgage and protection needs, tailored to your individual circumstances. It will also be part of our qualifying process that you speak with our Mortgage Adviser when we ask the vendor to consider your offer. Your details may be passed onto third parties, please advise us if you do not wish this to happen.

Money Laundering regulations 2003: It is a mandatory requirement that all purchasers and sellers produce identification documentation before we can proceed with any sale. We thank you for your co-operation. Services: We regret that none of the services, equipment or appliances at the property have been tested by ourselves and therefore we cannot guarantee their working order or condition. Potential purchasers are strongly advised to carry out their own tests or enquiries before finalising their purchase. These particulars are issued as a general guide and do not form part of any contract nor do they at any stage represent factual information. Starkey & Brown trading as Starkey & Brown Ltd, 34 Silver Street, Lincoln, LN2 1EH. Company Registration Number 6081031

The information is provided and maintained by Starkey & Brown Estate Agents, Lincoln. Please contact selling agent or developer directly to obtain any information which may be available under the terms of the Energy Performance and Buildings (Certificates & Inspections) (England & Wales) Regulations 2007 and the Home Information Pack Regulations 2007.

Important Information:
All measurements are approximate. We have not tested any appliances or services within this property and cannot verify them to be in working order or within the vendors's ownership. We have not verified the tenure of the property, type of construction or the condition thereof. Intending purchasers should make appropriate enquiries through their own solicitors and surveyor etc, prior to exchange of contract.

1 Oswald Road, Scunthorpe, DN15 7PU
T: 01724 856100
E: scunthorpe@starkeyandbrown.co.uk



www.starkeyandbrown.co.uk



**STARKEY
& BROWN**
YOUR LOCAL PROPERTY PEOPLE