

Buy. Sell. Rent. Let.



Suggitts Court, Cleethorpes



When it comes to  
property it must be

  
lovelle





£140,000



Welcome to this end terrace dormer bungalow which is a deceptively spacious home. Set in a popular residential area on a small cul-de-sac just off Suggitts Lane, located off Grimsby Road, close to local amenities, shops and schools, within walking distance into Cleethorpes town centre.

### Key Features

- End Terrace Dormer Bungalow
- Lounge
- Kitchen/Diner
- Two Bedrooms
- Bathroom
- Additional Shower Room
- Allocated Parking
- Enclosed Rear Garden
- EPC rating D
- Tenure: Freehold







Welcome to this end terrace dormer bungalow which is a deceptively spacious home. Set in a popular residential area on a small cul-de-sac just off Suggitts Lane, located off Grimsby Road, close to local amenities, shops and schools, within walking distance into Cleethorpes town centre.

The accommodation briefly comprises of: lounge, kitchen, bathroom, two double bedrooms one been on the first floor including shower room. Benefiting from a enclosed rear garden.

Viewing comes highly recommended!

### Entrance Porch

1.33m x 1.17m (4'5" x 3'10")

### Lounge

3.36m x 4.60m (11'0" x 15'1")

### Kitchen

4.80m x 2.33m (15'8" x 7'7")

### Bedroom

3.19m x 2.55m (10'6" x 8'5")

### Bathroom

2.06m x 1.93m (6'10" x 6'4")

### Landing

0.00m x 0.00m (0'0" x 0'0")

### Bedroom

4.49m x 4.93m (14'8" x 16'2")

### Shower Room

1.93m x 1.93m (6'4" x 6'4")

### Council Tax Information

The Council Tax Band for this property is A. This information was obtained in July 2024 and is for guidance purposes only. Purchasers should be aware that the banding of the property could change if information is brought to light that makes it clear to the Valuation Office Agency that an error was made with the original allocation. additionally, there may be circumstances when the Council Tax can be altered on change of ownership. All interested parties are advised to make their own enquiries. See [www.gov.uk/council-tax-bands](http://www.gov.uk/council-tax-bands)



## Services

All mains services are led to be available or connected subject to the statutory regulations. We have not tested any heating systems, fixtures, appliances or services.

## Mortgage And Services

Lovelle Estate Agency and our partners provide a range of services to buyers, although you are free to use an alternative provider. If you require a solicitor to handle your purchase and/or sale, we can refer you to one of the panel solicitors we use. We may receive a fee if you use their services. we can refer you to the Mortgage Advice Bureau who are in-house. We m services.

## Viewing

By appointment with the Sole Agent Lovelle Estate Agency, telephone 01· We recommend prior to making an appointment to view, prospective pur likely to affect their interest in the property with one of our property cons order that you do not make a wasted journey.

## How To Make An Offer

If you are interested in this property then it is important that you contact us at your earliest convenience. We will require certain pieces of personal information from you in order to provide a professional service to you and our client. The personal information you have provided to us may be shared with our client, the seller, but it will not be shared with any other third parties without your consent other than stated reasons detailed within our privacy policy. More information on how we hold and process your data is available on our website <https://www.lovelle.co.uk/privacy-policy/> and you can opt out at any time by simply contacting us.

For any offer you wish to make we will need to establish certain details before negotiation can take place. This is so that our vendor can make an informed choice when negotiating and accepting your offer. You will be asked to provide formal I.D. and address verification, as required under new Money Laundering Legislation. You might also have one or two questions for us, such as which solicitor to choose, or which mortgage lender has the best offers available for me. We have a one stop shop to satisfy all of these needs so please ask.

## Energy Performance Information

A copy of the full Energy Performance Certificate for this property is available upon request unless exempt. Advisory Notes - Please be advised if you are considering purchasing a property for Buy To Let purposes, from 1st April 2018 without an EPC rated E or above it will not be possible to issue a new tenancy, or renew an existing tenancy agreement.

## Agents Note

These particulars are for guidance only. Lovelle Estate Agency, their clients and any joint agents give notice that:-

They have no authority to give or make representation/warranties regarding the property, or comment on the SERVICES, TENURE and RIGHT OF WAY of any property.

These particulars do not form part of any contract and must not be relied upon as statements or representation of fact.

All measurements/areas are approximate. The particulars including photographs and plans are for guidance only and are not necessarily comprehensive.

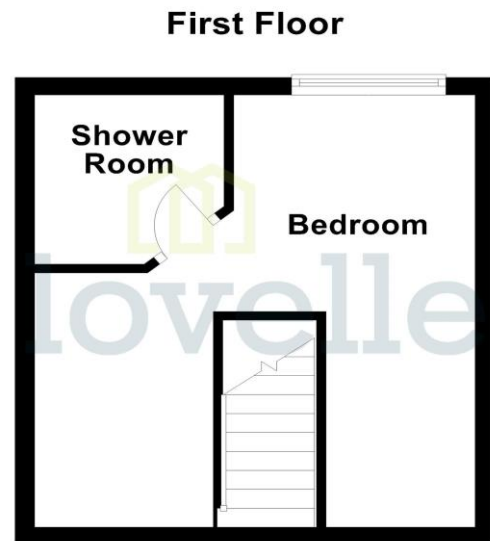

| Score | Energy rating | Current | Potential |
|-------|---------------|---------|-----------|
| 92+   | A             |         |           |
| 81-91 | B             |         | 86 B      |
| 69-80 | C             |         |           |
| 55-68 | D             | 64 D    |           |
| 39-54 | E             |         |           |
| 21-38 | F             |         |           |
| 1-20  | G             |         |           |

When it comes to **property**  
it must be

  
**lovelle**

01472 812250

humberston@lovelle.co.uk

