

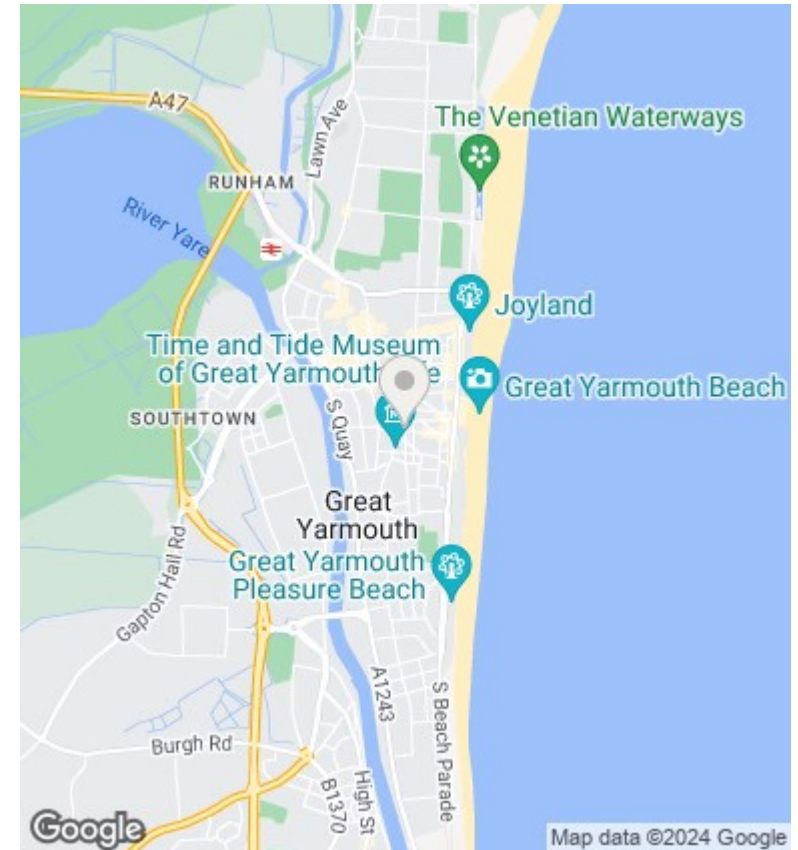

110 Nelson Road Central, Great Yarmouth, Norfolk, NR30 2NJ

£1,550 PCM

- Modern Throughout
- Five Bedrooms
- Fully Renovated
- Lots of Space
- Two Bathrooms
- Permit Parking
- Modern Kitchen
- Mid Terrace

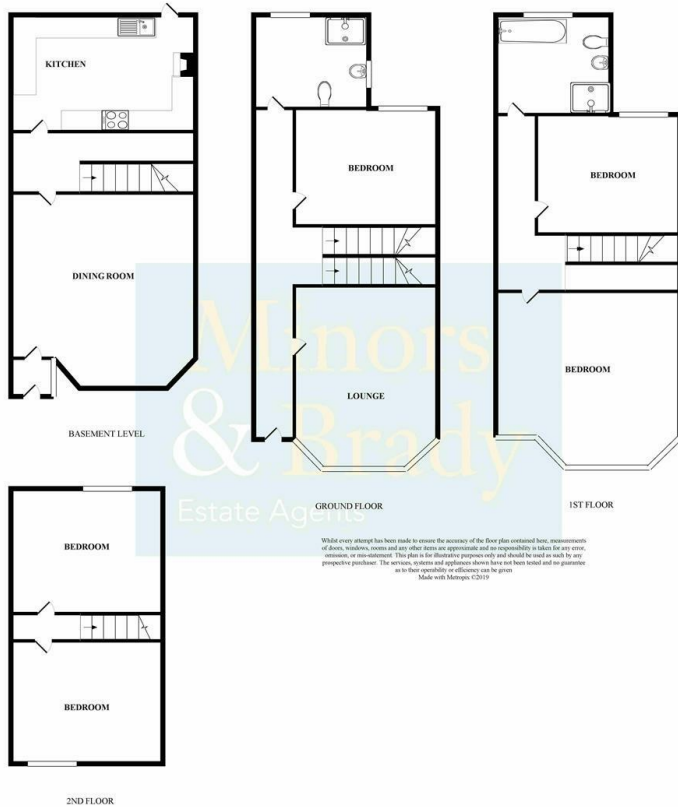

Directions

, Great Yarmouth

Viewings

Viewings by arrangement only. Call 0203 551 6141 to make an appointment.

Council Tax Band

EPC Rating:

Energy Efficiency Rating		
	Current	Potential
<i>Very energy efficient - lower running costs</i>		
(92 plus) A		
(81-91) B		
(69-80) C		
(55-68) D		
(39-54) E		
(21-38) F		
(1-20) G		
<i>Not energy efficient - higher running costs</i>		
England & Wales	EU Directive 2002/91/EC	