

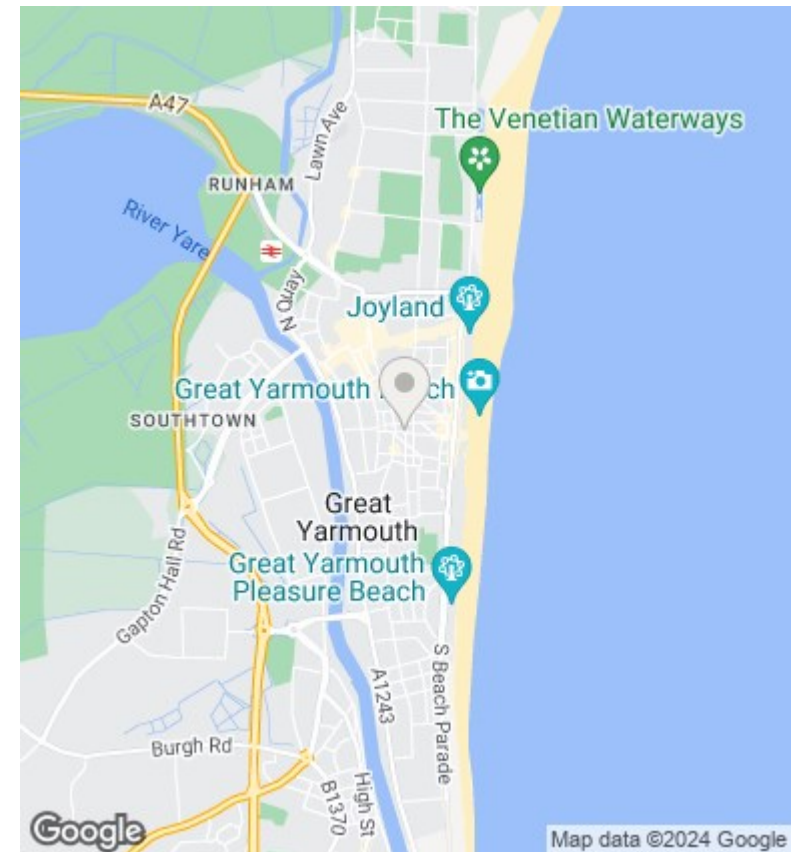

|., 110 Nelson Road Central, Great Yarmouth, Norfolk, NR30 2NJ

£1,550 PCM

- Modern Throughout
- Five Bedrooms
- Fully Renovated
- Lots of Space
- Two Bathrooms
- Permit Parking
- Modern Kitchen
- Mid Terrace

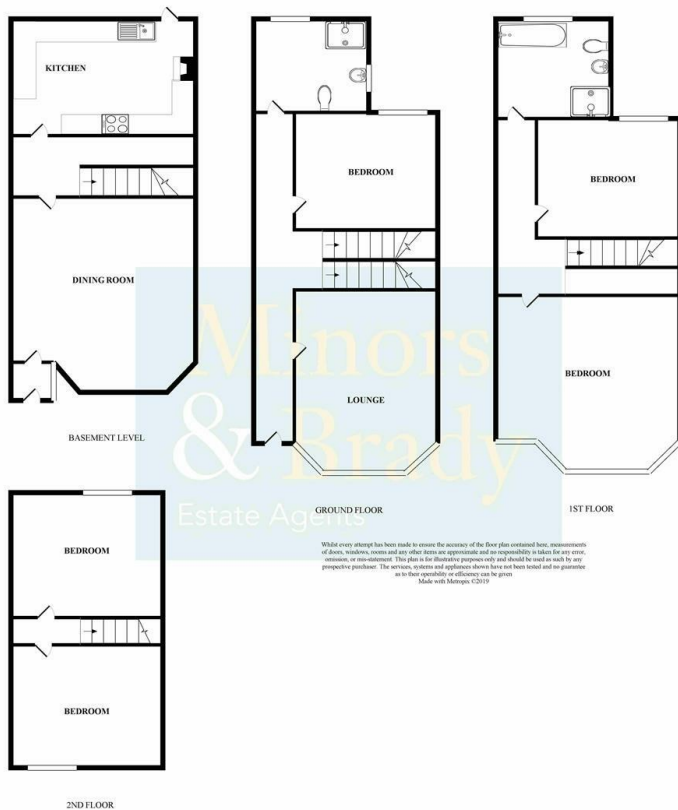

## Directions

, Great Yarmouth

## Viewings

Viewings by arrangement only. Call 0203 551 6141 to make an appointment.

## Council Tax Band

## EPC Rating:

Energy Efficiency Rating		
	Current	Potential
<i>Very energy efficient - lower running costs</i>		
(92 plus) <b>A</b>		
(81-91) <b>B</b>		
(69-80) <b>C</b>		
(55-68) <b>D</b>		
(39-54) <b>E</b>		
(21-38) <b>F</b>		
(1-20) <b>G</b>		
<i>Not energy efficient - higher running costs</i>		
<b>England &amp; Wales</b>	EU Directive 2002/91/EC	